

SURVEY PLAN MANUAL

**PROVISIONAL
COPY**

ISSUED BY
SURVEYORS BOARD
OF QUEENSLAND
1978

THE PROCEDURES SET OUT IN THIS MANUAL ARE RECOMMENDED
IN SUPPORT OF REGULATION 38, SURVEYORS REGULATIONS 1978,
AND ARE TO BE COMPLIED WITH TO THE DEGREE NECESSARY TO ACHIEVE
A REASONABLE UNIFORMITY IN PLAN DRAWING PRACTICE IN THE
RECORDING OF SURVEY INFORMATION.

FOREWORD

The aim of this manual is to advise on drafting procedures generally, and to help in providing an accurate and clear representation of the information as supplied by the surveyors record of survey, in order that uniformity in standard of presentation be achieved.

It is considered desirable that the general format be followed and that the plan satisfies the purpose for which the survey is intended.

If mechanical guides and stencils are used there must be conformity with the general standard of lettering on the specimen plans.

Plans drawn shall be capable of being satisfactorily reproduced on a reduced scale.

This manual is issued in this Provisional Edition to ensure that surveyors have immediate guidance on the requirements of the Surveyors Board. Users are requested to inform the Board of any amendments they consider necessary or beneficial.



PRESIDENT, SURVEYORS BOARD

CONTENTS

DETAILED DRAFTING STANDARDS.....	Pages	5 - 40
DEPARTMENTAL REQUIREMENTS		
(1) Department of Mapping and Surveying..... (DMS)	Pages	41 - 62
(2) Department of Mines.....	Page	63 - 80
(3) Titles Office.....	Page	81 - 84
SPECIMEN PLANS.....	Page	85

**DETAILED
DRAFTING
STANDARDS**

METRIC DOCUMENTATION

7.

1. The symbol "m" will NOT be shown following a length.

e.g. 20·115 not 20·115 m

2. The decimal point is to be prominently placed at the mid height of the figures.

3. Numbers should be grouped in threes right or left from the decimal point, and a space should be used instead of a comma.

e.g. 65 093·762 13 not 65,093·76213

However, except in tabular work (eg. co-ordinates), the space may be omitted in groups of only four figures.

e.g. 4076·3012

4. A space should be left between the numeral and the unit or unit symbol.

e.g. 2076 m² (not 2076 m²)

5·273 ha (not 5·273 ha)

5. No full stops will follow symbols.

6. Use of "zeros".

- (a) Where the figure is less than one, use a zero before the decimal point.

e.g. 0·745 not ·745

- (b) For whole numbers, a zero will be shown as the last character of length to the right of the decimal point.

e.g. 4·0 , 51·0 , 200·0

Not 4·00 or 501·20 or 67·530

7. Rounding: When rounding to fewer digits than the total number available, the following procedure is adopted.

- (a) Where the digit immediately following the last digit to be retained is less than 5, that digit should be left as is.

e.g. 7·624 25 to four digits = 7·624

- (b) When the digit immediately following the last digit to be retained is 5 or greater, that digit should be increased by one.

e.g. 4·624 51 to four digits = 4·625

- (c) If the digit to be discarded is exactly 5 and there is no indication of what the following digits might be, the last digit retained should be rounded to the nearest even digit.

e.g. 5·465 rounded to 2 decimals becomes 5·46

5·455 rounded to 2 decimals becomes 5·46

NOTE : IT IS ESSENTIAL THAT THE DECIMAL POINT BE SHOWN AS CLEARLY AND PROMINENTLY AS POSSIBLE.

ABBREVIATIONS

See Page 27.

ADJOINING DESCRIPTIONS

(a) All adjoining information will be shown in sloping hairline.
See 'STYLES'—Page 33.

Specific sample information.

Unsubdivided Portion	POR. 16	or	POR. 16
	SI. 681		SI. 681
Subdivided Portion			
(1) Sub 1 of Resub 2 of Por. 16	1	or	1
	RP 1642		Cg. 672
(2) Lot 2 on RP 156432	2		
	RP 156432		

Subs etc of Miners Homesteads will be similar to (1)

(b) For DMS plans, Portion numbers are always shown even when subdivision has taken place as per Unsubdivided Portion.

(c) Latest adjoining descriptions must be shown.

See also 'SPECIMEN PLANS'—Page

ALIGNMENT SPIKES

See 'REFERENCE MARKS'—Page 21.

ALLOTMENTS

Subject allotment numbers are always shown on street frontages.

See also 'STYLES'—Page 33.

ALTERATIONS AND ADDITIONS

See 'DEPARTMENTAL REQUIREMENTS'

AMG CONNECTIONS

Whenever any survey has been connected to a co-ordinated point on the Australian Map Grid (AMG), the co-ordinates can be tabulated.

AMG CO-ORDINATES (ZONE.....)

COR	EAST	NORTH	GRID	CONVERG
-----	------	-------	------	---------

Note: Origin of co-ordinates and date of adjustment should be indicated.

AREAS

- (a) New surveyed parcels of land may be calculated and shown:—
 - (1) In square metres to the nearest square metre where parcel is less than one hectare.
 - (2) In hectares to four significant figures.
 - (3) Where land is of very small extent (less than one square metre) and of high value (inner city area), area may be shown to not more than one decimal point.
- (b) When amendments to existing blocks occur, the area shown is a balance (or addition) or may be calculated if close indicates balance area suspect or balance area completely resurveyed.
Balance areas must be described accordingly on plan, i.e. "Balance" or "Bal".
- (c) For Imperial Conversions : See 'DEPARTMENTAL REQUIREMENTS'
See 'SPECIMEN PLANS'—Page

BEARINGS

- Bearings are shown upright on face of plan, sloping in all tabulations, and in a clockwise direction for completed blocks.
- Bearings will be shown in degrees, minutes and seconds, rounded off as appropriate, reduced to the meridian of the survey.
- It is preferable that the following use of 'O' be adopted.
270° 0', 270° 03'

Note that 270° 00' 00" is to be avoided.

BROAD ARROW

See 'REFERENCE MARKS'—Page 21.

BUILDINGS

- If encroachment is under consideration this must be clearly illustrated.

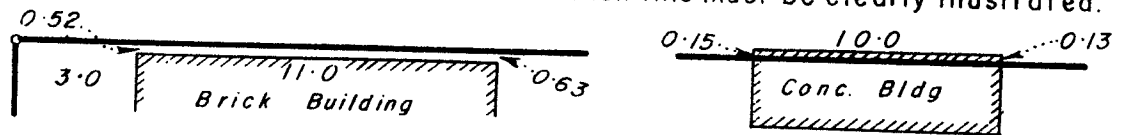

- Other improvements such as bridges, dams, mine shafts etc, may be shown if connected to in course of survey.
On Titles Office plans, however, structural improvements should be shown only if encroachment is under consideration.
- When classified as a reference mark (immovable object), connections thereto may be shown on face or tabulated in required manner.
See 'REFERENCE MARKS'—Page 21.

CALCULATED LINES

- Broken lines with computed bearings and distances.

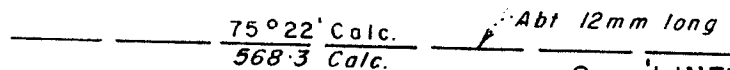

See 'LINEWORK'—Page 17.

- If appropriate to tabulate..... 'calc.' outside column.

CANCELLED BOUNDARIES

These are boundaries rendered redundant by new survey and are shown by broken lines of about 6mm lengths. See 'LINEWORK'—Page 17.

Once cancelled they are no longer shown on future plans.

See 'LAPSED BOUNDARIES'—Page 16.

- TITLES OFFICE : Not shown.
- DMS : If rerun — shown with dimensions on face or tabulated in traverse column.
- MINES DEPT : Shown with all dimensions on face or tabulated in traverse column..... original indicated.

ENTRE LINES

ROAD.... (a) TITLES OFFICE : Nothing shown.

(b) DMS AND MINES DEPT

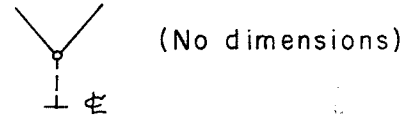

RAILWAY.....

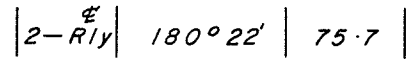
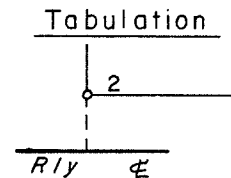
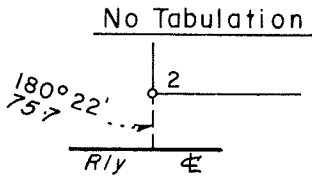

Shown in traverse column.

CITIES

Cities as gazetted under the Local Government Act are

- | | | |
|-----------------|-------------|-------------|
| BRISBANE | GYMPIE | ROCKHAMPTON |
| BUNDABERG | IPSWICH | TOOWOOMBA |
| CAIRNS | MACKAY | TOWNSVILLE |
| CHARTERS TOWERS | MARYBOROUGH | WARWICK |
| GLADSTONE | MOUNT ISA | |
| GOLD COAST | REDCLIFFE | |

COLOURS

Everything is BLACK.

COMPASS SURVEY

When part of the boundary of a block has been previously surveyed by compass, a noting as illustrated hereunder, has to be shown on face of plan.

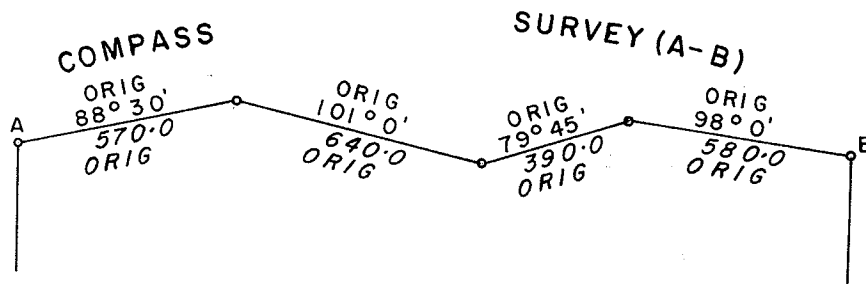

COMPILED PLANS (Plans without field survey)

- (a) DMS
 (b) TITLES OFFICE
 MINES DEPT
- } See 'DEPARTMENTAL REQUIREMENTS' (also Regulation 29)

CONNECTIONS TO DISTANT POINTS

Lighthouses, Beacons, T.V. Towers etc.

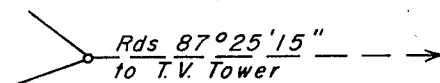

(Distance shown if measured)

CORNER INFORMATION

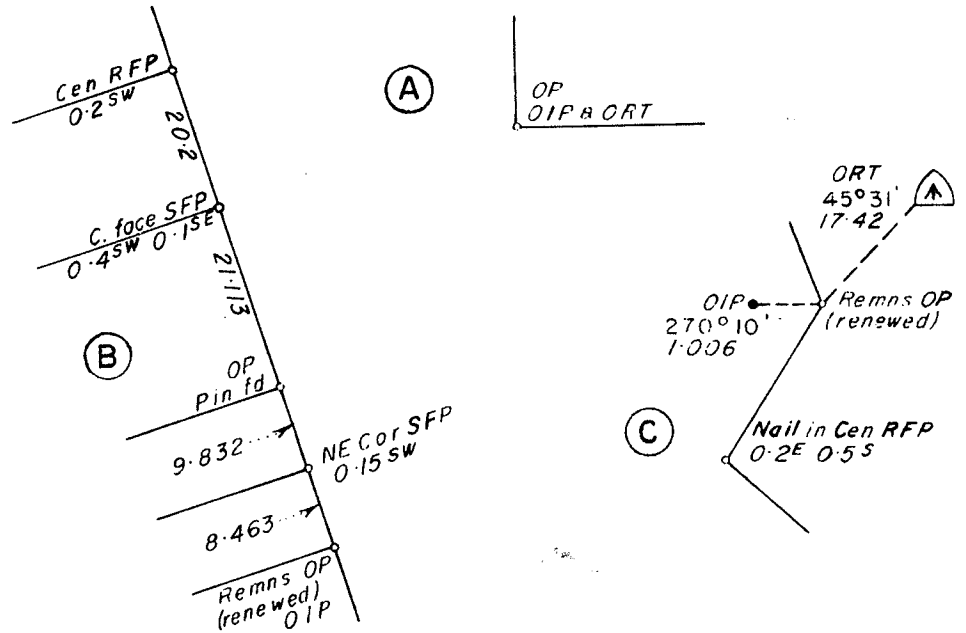

- (a) Information marking the corner should be written first. See (A)
- (b) When tabulation is not involved, information can be shown as in (C)

NOTE: A MIXTURE OF (A) AND (C) ON ONE PLAN IS TO BE AVOIDED.

- (c) The word "found" (fd) written after a mark e.g. Peg fd, Pin fd, PM fd denotes a mark with no apparent origin or no previous cadastral connection. See (B)
- See also 'REFERENCE MARKS' - Page 21 and use in conjunction.

COUNTY BOUNDARY

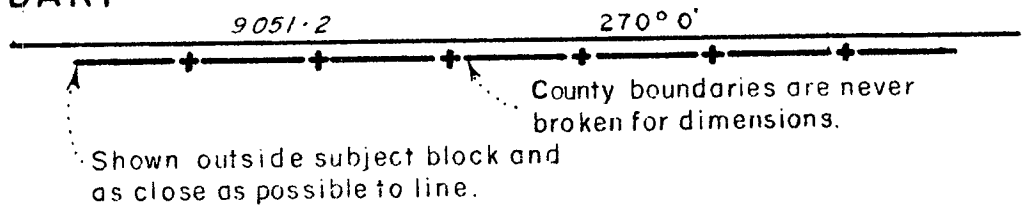

County boundaries are never broken for dimensions.

Shown outside subject block and as close as possible to line.

Note..... boundary is not to be shown in middle of roadway.

CREEKS

See 'WATERCOURSES' - Page 26.

DATUM



(a) For cancelled boundary or traverse.

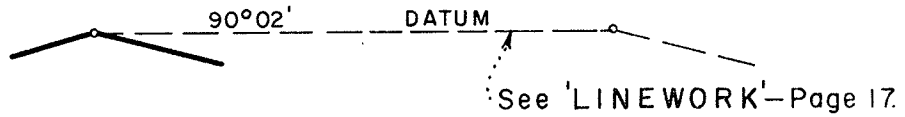

(b) Where there are insufficient marks for a datum on one line, the following may be adopted.

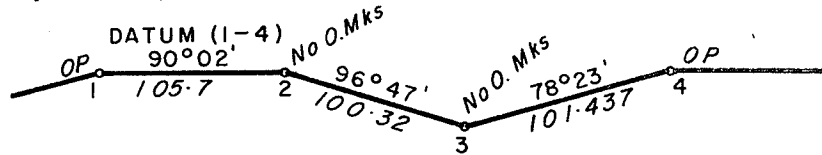

(c) When datum is an offset line, show "DATUM" on boundary if offset line can be omitted.

(d) When datum is obtained by observation for meridian, show "DATUM BY OBS" on appropriate line.

DESCRIPTION OF COUNTRY

- (a) TITLES OFFICE : Not required.
- (b) DMS : See 'DEPARTMENTAL REQUIREMENTS'-Page 58.
- (c) MINES DEPT : Not required except for natural features. See 'NATURAL FEATURES'-Page 18.

DIAGRAMS

- (a) On face of plan show..... SEE DIAGRAM A
- (b) Roads..... if block on plan, show hairline on diagram.
- (c) Enclose all diagrams in a border to separate from rest of plan. (straight lines preferred)
- (d) Diagrams should be drawn to scale if possible.
- (e) Where more than one diagram is shown on the one plan they should be labelled consecutively A, B, C etc.

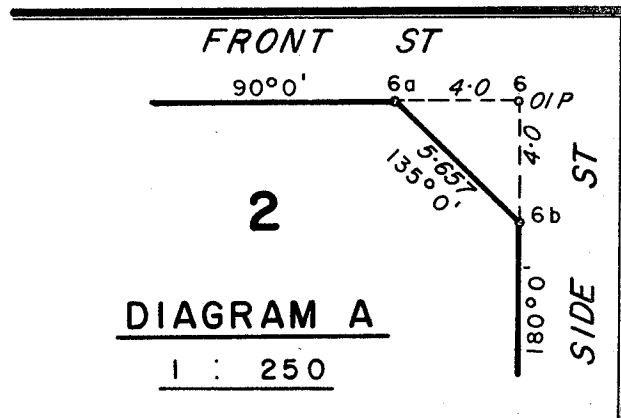

Note: 6-6a and 6-6b will be tabulated as required.

GEODETIC TRAVERSE

(a) Geodetic Traverses are to be tabulated as follows :-

GEODETIC		TRAVERSES		} Show whether M.S.L. or Meas.
LINE	FORWARD AZ	REVERSE AZ	DIST. (\nearrow)	

If more than one type of distance used, qualify outside of table only.

(b) See also 'AMG CONNECTIONS'—Page 9.

IDENTIFICATION SURVEY..... See 'DEPARTMENTAL REQUIREMENTS'
(also Regulation 30)

IMPROVEMENTS..... See 'BUILDINGS'—Page 10.

INACCESSIBLE LINES..... See 'CALCULATED LINES'—Page 10.

IRON PINS..... See 'REFERENCE MARKS'—Page 21.

KILOMETRE PEGS

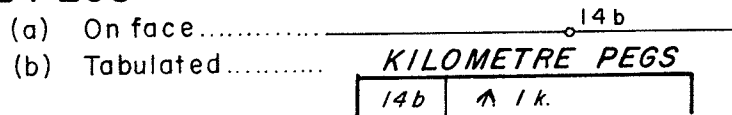

LAPSED BOUNDARIES

These apply to DMS and MINES DEPT plans only.
See 'LINEWORK'—Page 17.

(a) MINES DEPT : Lapsed boundaries are boundaries of dead leases. They are generally only shown when used for survey reinstatement. Measured bearings and distances are shown on face of plan. Former description of the expired lease when required is shown in dotted hairline.

(b) DMS : Lapsed boundaries are original portion boundaries. Portion numbers will be either subject or adjoining style.

LINE PEGS

New : (a) When survey record lodged — nothing on plan.

(b) When survey record not lodged—placement of line pegs will be indicated by one of the following methods.

(1) Statement i.e.....

Line pegs placed at intervals of 200.0
from stns 1, 3, 6, 12 and 15.

(2) Tabulation.....

LINE PEGS		
STN	BEARING	DIST.
2	180°42'	203.53
	"	406.22
	"	600.3
5	272°33'	201.42
	"	400.63

Original : Show..... OLP

Approximate distances if given in survey records serve to fix position of OLP only and must not be shown on plan.

LINework

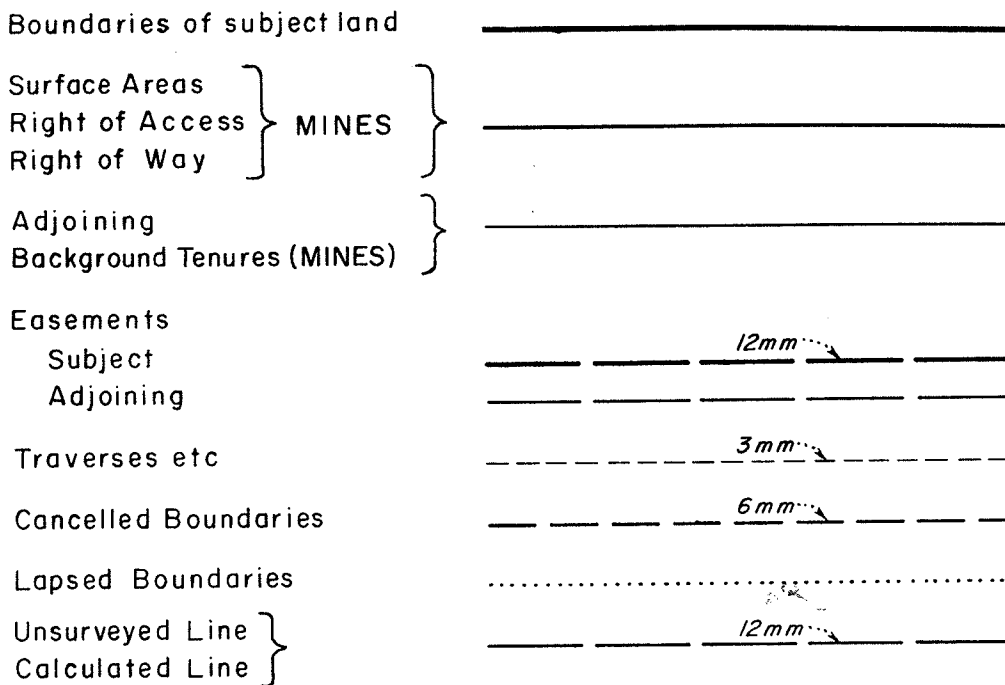

LOTS

- (a) Lot numbers are generally shown on street frontages.
- (b) See also 'DEPARTMENTAL REQUIREMENTS'

MRD PEGS

Nothing shown.

MRD BENCH MARKS

Tabulate under 'REFERENCE MARKS'	5	MRD/BM (Iron bk)	235° 02'	3.45	MR. 1k.
----------------------------------	---	---------------------	----------	------	---------

MARKS (M) ETC IN CONCRETE

See 'REFERENCE MARKS' - Page 21.

MEASUREMENT ONLY

- (a) Show as required on face of plan *(Mmt only)* 257.6
- (b) When tabulated | 1 - 7 | *Mmt only* | 13.53 |
(In 'TRAVERSES ETC' Column)

MERIDIAN

- The meridian of every survey should be indicated in the 'Meridian' box on the plan.
- (a) "On meridian of" or "CAM Vide....." and plan catalogue numbers quoted.
 - (b) If observation taken, details should be tabulated on plan by either of the following methods.

MERIDIAN			OBS		
STN	TBRO	CONV	STN	OBS	CAM

Result : CAM, addition or subtraction for CAM, shown in meridian box.

- (c) True Meridian and AMG : indicated when applicable.

METRIC DOCUMENTATION

See Page 7.

NAILS

Nails are normally shown only when

- (a) In RFP *Nail in
Cen RFP*
- (b) If placed in concrete, bitumen etc..... Treat exactly the same (on face and in tabulation) as Pins and Original Iron Pins. See 'REFERENCE MARKS'—Page 21.
- (c) The type of nail can be shown if indicated in Survey Records. (Spring Head, Jolt Head, Clout, Ramset etc) See 'ABBREVIATIONS'—Page 27.

NATURAL FEATURES

While description of country is shown only on plans to be lodged in the DMS, both MINES DEPT and DMS plans require natural features such as gullies, mountain ranges etc, to be shown if located in course of survey

NO MARKS PLACED

Used if appropriate.

NO ORIGINAL MARKS

- (a) No O. Marks This means there is no survey mark previously placed at or referred to the corner.
- (b) No Marks This term is never shown on plan.

NORTH POINT

- (a) North Point is not shown unless plan is turned i.e. when 270° becomes 0° .
- (b) When plan is turned All information is shown accordingly, that is To the North Point. (This includes tabulations and statements)
- (c) See also 'TABULATION'—Page 25.

NOT TO SCALE

Use with discretion. Break line for each block affected. Advantageous to plot this work to 'some scale' for sake of proportional representation. The wording "Not to Scale" is to be shown on appropriate line or lines.

NOTE: NEW SURVEYED LINES AND SUBJECT BLOCKS ARE DRAWN TO SCALE.

OCCUPATION

Unmarked improvements such as Fence Posts, Walls, Buildings, Poles, ManHoles or any such immovable objects which are connected to in the course of the survey, and IN ADDITION TO THE MONUMENT DENOTING THE CORNER, are generally classed as "occupation". These are supplementary references to the corner, and can be entered in the 'REFERENCE MARKS' column. See Page 21.

OFFSETS

Not shown on plan in normal circumstances

- (a) If sufficient connections to boundary line have been made, all information is to be related to the boundary line.
- (b) If there are insufficient connections, offset will be shown.

ORIGINAL DIMENSIONS

- (a) Shown with 'ORIG' written in conjunction with each bearing and distance. 'Bal.' and 'By Addn' to be used where applicable.

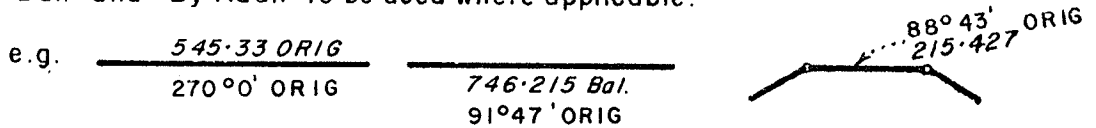

- (b) All conversions to metric will be given to 3 decimal places.

When utilising "original dimensions" an endorsement is required stating the source of this information.

- e.g. *Original information compiled from Sl. 1234 in the ~~Office of the Surveyor General~~. Dept of Mapping + Surveying.*
- or *from RP. 12345 in the Titles Office* { *Brisbane*
Rockhampton
Townsville
- or *from M.P. 10537 in the Mines Dept, Brisbane*

ORIGINAL MARKS

- (a) Where the origin of any mark is unknown the mark should be described by "found" i.e. *Peg fd, Pin fd*. See also 'CORNER INFORMATION'— Page 12.
- (b) Where the origin of a mark is known but is not evident on the plan being drawn. (This applies particularly to MINES DEPT), the mark may be identified by the addition of the catalogue number of plan of origin.

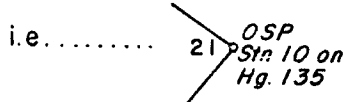

- (c) See also 'CORNER INFORMATION, LINE PEGS, NO ORIGINAL MARKS, PEGS, PERMANENT MARKS, POINTER PEGS, REFERENCE MARKS, RENEWED, RESET, SURVEY POSTS'.

ORIGINAL PEGS

See 'PEGS'—Page 20.

PARISH BOUNDARY

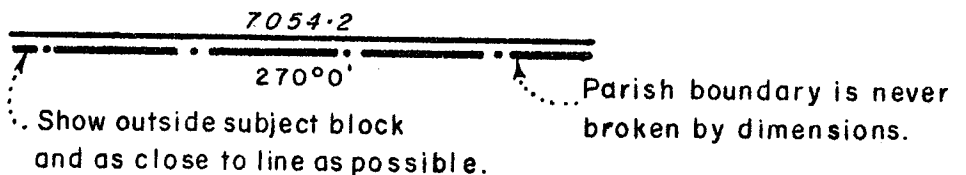

Note: Parish boundary is not to be shown in middle of Roadway.

PEGS

- New : (a) "Peg placed" is shown on face of plan only when placed at an original corner.
- (b) Branded new pegs are to be listed by statement as follows :
Branded peg placed at stns 2,7,9,14-17. or Branded pegs placed at all new corners.
 (if appropriate)
- Similar notings may be adopted for unbranded pegs if required.
- (c) Variations such as Peg placed in cairn of stones, Peg driven flush, Plastic or Concrete Peg placed, Star Picket placed etc, must be indicated either on face or by statement.

Original :

Use "OP", Remains "OP", "OP hole" etc.

See also 'KILOMETRE PEGS'—Page 16.

PERMANENT MARKS

When pm was previously installed but not connected show: pm fd. not OPM. i.e. same for Op

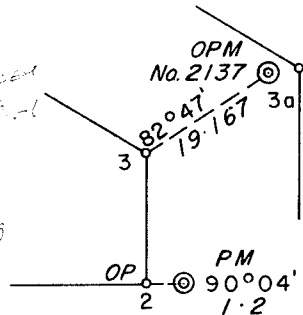

NO TABULATION

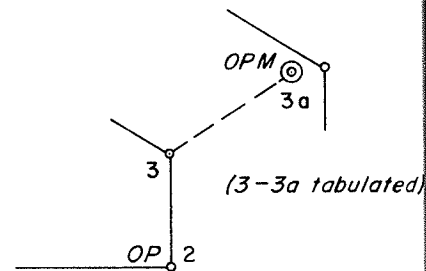

PERMANENT MARKS			
PM	BEARING	DIST	No
2- PM	90°04'	1.2	
3a OPM	at	stn	2137

WITH TABULATION

When co-ordinates have been established, these may be treated as follows :

- (a) Entered in 'AMG CONNECTIONS' tabulation.

AMG CO-ORDINATES (ZONE.....)			
COR	EAST	NORTH	GRID CONVERG
PM 1643	723 659.96	7 657 837.81	

- (b) Added to existing PERM. MARK tabulation in a suitable format.

PINS

See 'REFERENCE MARKS'—Page 21.

PLOTTING

Plots shall be accurate to within 1 part in 150. The co-ordinate system of accuracy control should be used where necessary to achieve the required standard.

POINTER PEGS

See 'REFERENCE MARKS'—Page 21.

POLES

Electric Light Poles, Power Poles, Telegraph Poles etc. to be treated as per "Reference Marks". See 'REFERENCE MARKS'—Page 21.

RAILWAYS

For connections to see 'CENTRE LINES'—Page 11.

RANGED ONLY AND READ BEARINGS

Shown as follows :

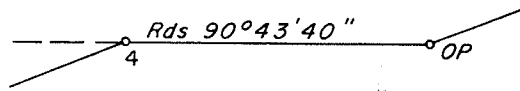
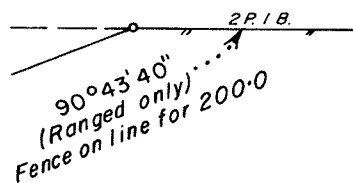

See also 'FENCES'— Page 15.

REFERENCE MARKS

A reference mark is a suitably marked tree, fence post, or durable mark on a building or other immovable object, or a pin of a durable material not less than 15mm x 300mm driven flush into a paved surface or at least 50mm below an unpaved surface. This thus embraces trees, pins, spikes, nails, screws, broad arrows, drill holes and other marks in fixtures, original pointer pegs, fence posts and marks on poles etc. in relation to which the true position of a corner can be established.

ALL CONNECTIONS WILL BE FROM THE CORNER TO THE REFERENCE MARK.

On face or tabulation treatment may be adopted.

- (a) On face: Reference marks and connections thereto may be shown on face of plan. Following diagram illustrates format to be adopted.

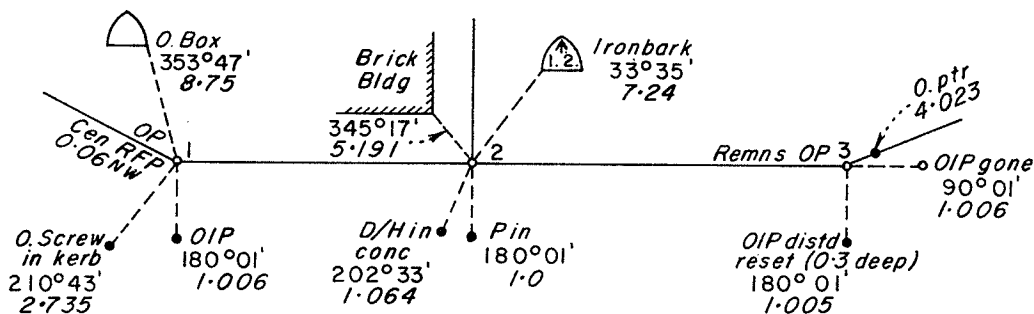

When "on face" representation is adopted, plan must show a prominent note. REFERENCE MARK CONNECTIONS ARE FROM THE CORNER TO THE MARK.

- (b) Tabulation treatment: Format involves tabulating all reference marks in the one column headed 'REFERENCE MARKS'. On face representation and tabulation will be as follows:

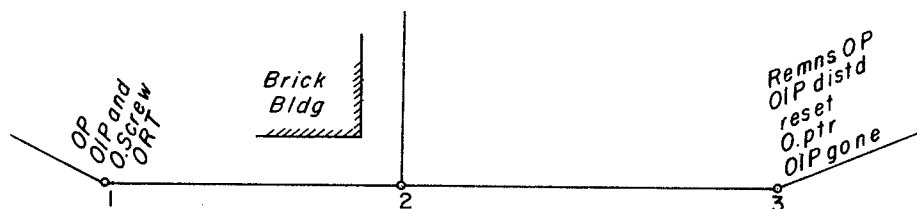

- (c) It is preferable that (a) or (b) be adopted in its entirety where possible, rather than mixtures of "on face" and "tabulation" take place.

SEE NEXT PAGE FOR TABULATIONS OF (b) ABOVE.

REFERENCE MARKS (contd)

REFERENCE		MARKS		
STN	TO	BEARING	DIST	BRAND
1	OIP	180°01'	1.006	
	O.Screw in kerb	210°43'	2.735	
	O.Box	353°47'	8.75	
	Cen RFP	0.06NW		
2	Pin	180°01'	1.0	
	Ironbark	33°35'	7.24	A. 1.2
	Cor Bldg	345°17'	5.191	
	D/H in conc.	202°33'	1.064	
3	OIP reset	180°01'	1.005	0.3 deep
	OIP gone	90°01'	1.006	
	O.ptr	88°43'	4.023	

NOTE:

- (a) Listings are consecutive and all reference marks for a corner MUST BE KEPT TOGETHER.
- (b) The spacing shown between groupings does not necessarily have to be adopted when only one reference mark is recorded for station.

OTHER EXAMPLES

5	S.H. Nail in bitumen	94°06'	8.735	
	A. in PP 1361	35°43'30"	11.54	
7	Cen RFP	22°47'	4.08	
	Stp ORT	43°23'	6.58	
8	O. Bldwd	0°58'	10.07	A.R.57
	Ram. Nail in MH	53°47'40"	7.055	
	OIP	180°27'	1.0	

- (a) Recorded connections to the site of original documented reference marks should be shown.
- (b) Depths of pin placements should be indicated if other than standard.
- (c) See also 'CORNER INFORMATION' - Page 12.
- (d) Remember: For "on face" representation, plan must show a prominent note.

REFERENCE MARK CONNECTIONS ARE FROM THE CORNER TO THE MARK.

RENEWED

- (a) Old mark (or remains) removed and a new mark of the same type placed.
e.g. *Butt OSP Remns OP OP (distd) OIP (distd)*
(renewed) (renewed) renewed renewed
- (b) When old mark is removed and a new mark of a different type is placed, show as follows:
e.g. *OPremvd OIPremvd Butt OSP OIPremvd*
Post pld Peg pld Peg pld PM pld

Show on face and /or tabulate as required.

RESERVED ROADS

Unsurveyed road in a specific position show.....

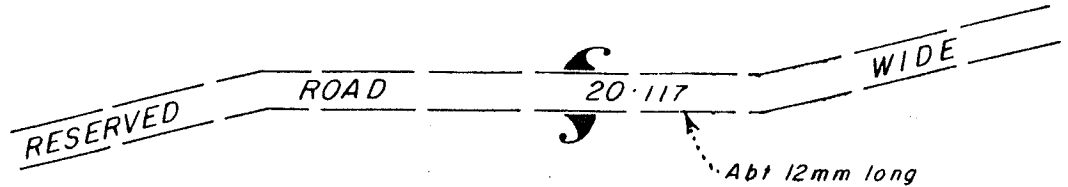

See 'LINEWORK' Page 17.

Area shown : **28.297 ha**
2.537 ha Resd Rd
25.76 ha

RESET

Existing mark out of ground or disturbed. This same mark is reset in correct position.....

OP (distd) reset *OLP lying reset*

For IRON PINS

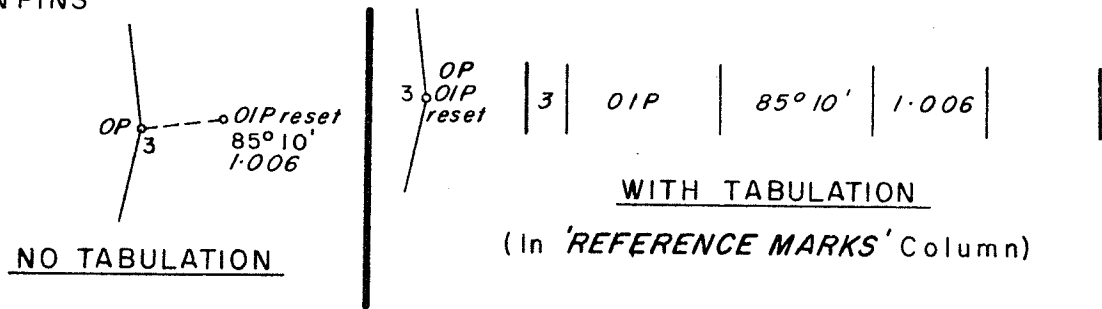

RESURVEY

- (a) When a resurvey of an existing tenure is carried out with a view to correction of title or instrument of lease, the normal plan requirements shall apply, except that the plan title should read :

RESURVEY OF.....

- (b) See 'DEPARTMENTAL REQUIREMENTS' for Identifications and Remarkings.

See 'WATERCOURSES'—Page 26.

RIVERS

ROADS

- (a) Where only one side of road has been surveyed..... Calculated distances on unsurveyed side are not normally shown. See also 'MINES DEPT REQUIREMENTS'
- (b) Dimensions for internal roads shown for completed blocks. Use "ORIG" where applicable.
- (c) Refer to Main Roads Gazette for correct Road name. (Section names of Highways are not shown).
- (d) For roads forming boundaries of subject blocks, the width, when opposite side is shown, must be plotted to scale.
- (e) See DMS 'DEPARTMENTAL REQUIREMENTS'—Page 61 for 'UNSURVEYED ROADS'

ROAD RESERVATION

Area reserved for road purposes in no specific location.

Area shown : **46.635 ha**
3.075 ha Rd Resn
43.56 ha

SCALE OF PLANS

Plans should be drawn to one of the following scales, or multiples of powers of 10 thereof:

1 : 1	1 : 2.5	1 : 6
1 : 1.25	1 : 3	1 : 7.5
1 : 1.5	1 : 4	1 : 8
1 : 2	1 : 5	

SCREWS

See 'REFERENCE MARKS'—Page 21.

SECANTS

See 'LINEWORK'—Page 17.

Dimensions are shown on face or tabulated.

SHEET NUMBERS

This applies only to DMS and MINES DEPT plans, where job is of a nature that requires several sheets to show all necessary information. The following is to be adopted.

- The subject survey must be shown "to scale" on sheet 1.
- The same size plan form is to be used for each sheet.
- Each sheet should be labelled:
eg.....SHEET 2 OF 5 SHEETS
- Sheets should be endorsed along the joining edges as follows:—

eg.....JOINS SHEET 3

SPIKES

See 'REFERENCE MARKS'—Page 21.

STAR PICKETS

- If used in lieu of Iron Pin.... treat as such... See 'REFERENCE MARKS'—Page 20.
- If used in lieu of Peg.... treat as such..... See 'PEGS'—Page 20.
- If acceptable by DMS as a Perm. Mark..... treat as such..... See 'PERMANENT MARKS'—Page 20.

STATE BOUNDARY

Shown thus 
(Subject to same condition as 'PARISH BOUNDARY'—See Page 19.)

STATION NUMBERS

- Station numbers are to be shown in as simple a format as possible.....
i.e..... 1, 2, 3 with 1a, 1b etc for secants and close proximity only.
- Station numbers with "x" attached..... In general not to be used.

STEEL DROPPER:— See "Star Picket"

STREETS

See 'STYLES' and 'ROADS'

STYLES

See Page 33.

SURVEY POSTS

New: (a) Survey Post placed is shown on face of plan only when placed at an original corner.

(b) Table new survey posts by statement as follows:

e.g..... *Survey Post placed at stns.....*
Branded Survey Post placed at stns.....

Original: Show on face only
OSP- OSP hole- OSP distd- OSP lying reset

SYMBOLS

See Page 37.

TABULATIONS

When a plan has been 'turned', tabulations are to be treated likewise so as to facilitate easy reading of plan. See also 'NORTH POINT', 'TRAVERSES', 'REFERENCE MARKS', 'PERMANENT MARKS.'

TELEGRAPH POLES

See 'REFERENCE MARKS'—Page 21.

TOWN

Town or City as per published map..... See 'CITIES'—Page 11.

TRAVERSES

Traverse lines are to be omitted except along watercourses, at truncated corners, and in some cases official or declared alignments.

Dimensions are shown on face or tabulated. When tabulation is adopted, numerical order is preferred.

	<i>TRAVERSES</i>	<i>ETC</i>
1-2	180°07'	13.13
3-4	236°43'30"	105.26
5-5a	355°32'40"	20.117

(a) Where a traverse has been run to establish a new boundary along an inaccessible tract (cliff etc), the traverse is shown in the normal manner and the boundary shown calculated. See 'CALCULATED LINES'—Page 10.

(b) Where survey marks are placed on a traverse, these marks must be recorded on the plan.

See also 'DATUM, GEODETIC TRAVERSE, OFFSETS, WATERCOURSES'

See 'LINEWORK'—Page 17.

TRUNCATIONS

When a number of similar truncations are surveyed, the following statement is used at the end of the Traverse column.

e.g. Truncations are of 4.0
at stns 4, 6, 8, 12 and 15.

UNSURVEYED LINE

Shown thus



See 'LINEWORK'—Page 17.

WATERCOURSES

- (a) Show opposite bank of watercourse if practicable.

It is not always necessary, however, to show information on the other side of watercourse forming boundaries except for Parish and County names.

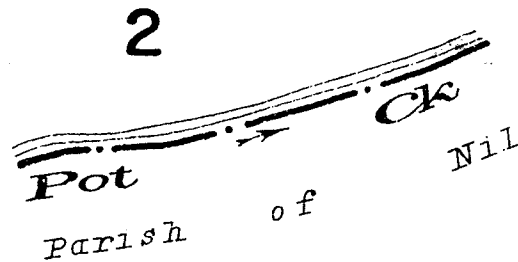

- (b) Distances on a boundary terminating at a watercourse are to include distance to:

- (1) Post or peg.
- (2) Traverse.
- (3) Bank or Watercourse Boundary. (Ck, Riv, etc)

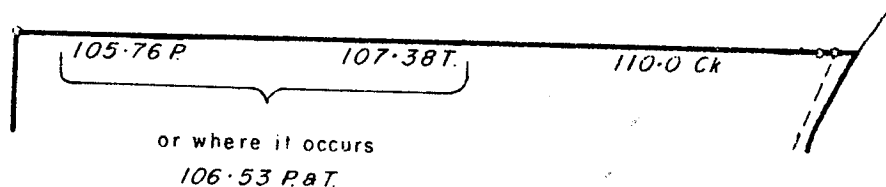

- (c) An arrow indicating "downstream" must always be shown.
- (d) While traverses of watercourses are to be indicated on plan when run, there is no necessity to show when original. The original Catalogue Number shown along the watercourse will suffice.
- (e) Offsets taken from traverse to watercourse are not to be shown on plan.

ement m

ther side
ames.

clude

ABBREVIATIONS

en run,
alogue

on plan.

GENERAL ABBREVIATIONS

About	Abt	Electric Light Pole	E.L.P.
Addition	Addn	Esplanade	Esp.
Alignment Spike	A. Spk.	Expressway	Expwy
Allotment	Allot	Extended	Ext'd
Alluvial Mining Claim	A.M.C.		
Application Post	Appln Post	<u>Fence Posts:</u>	
Approximately	Approx.	Round Fence Post	R.F.P.
Australian Grid Datum	A.G.D.	Square Fence Post	S.F.P.
Australian Height Datum	A.H.D.	Square Concrete Fence Post	Conc. S.F.P.
Australian Map Grid	A.M.G.	Round Steel Fence Post	} Steel F.P. or G.I.F.P.
Authority to Prospect	A. to P.	Round Galv. Iron Fence Post	
Avenue	Av	Steel Fence Post	
		Tubular Steel Fence Post	
Balance	Bal.	Corner Square Fence Post	Cor S.F.P.
Bank	Bk	Centre Round Fence Post	Gen. R.F.P.
Bitumen	Bit.	Centre Face Square Fence Post	Gen. Face S.F.P. (C. Face S.F.P.)
Boulevard	Bvd		
Brick	Br.	Freeway	Fwy
Brook	Brook	Foot	Ft
Building	Bldg	Found	Fd
Business Area	B.A.	Galvanised	Galv.
		Galvanised Iron	G.I.
Calculated	Calc.	Gold Field Homestead	G.F.H.
Centre	Gen. (C)	Gold Mining Lease	G.M.L.
Close	Cl	Ground	Gnd
Coal Mining Lease	C.M.L.		
Concrete	Conc.	Highway	Hwy
Connection	Conn	High Water Mark	H.W.M.
Corner	Cor	Holding	Hldg (H)
County	Cty		
Court	Ct	Identification	Ident.
Creek	Ck	Identification Survey	I.S.
Crescent	Cres.	Instruction	Inst.
		Intersection	Intsn
Datum Post	D. Post	Iron Pin	Pin
Dead	Dd	Island	Is.
Deduced	Ded		
Department of Mapping and Surveying	D.M.S.	Kilometre (s)	km.
Departmental	Deptl		
Developmental	Dev.	Leaning	Leang
Diagram	Diag.	Left Bank	L.Bk
Distance	Dist.	Licensed Gem Claim	L.G.C.
Disturbed	Distd	Licensed Surveyor	Licd Surv.
Dog Spike	D. Spk.	Local Government	Local Govt.
Dredging Area	D.A.	Low Water Mark	L.W.M.
Dredging Claim	D.C.		
Dredging Lease	D.L.	Machine Area	M.A.
Drill Hole	D.Hole (D/H)	Market Garden Area	M.G.A.
Drive	Dr.	Marks	Mks
		Measurement	Mmt
Easement	Emt	Metre (s)	m
East	E	Mile (s)	M

GENERAL ABBREVIATIONS (contd)

Mineral Claim	M.C.	Restricted Mining Claim	R. M.C.
Miner's Homestead Perpetual Lease	M.H.P.L.(P.L.)	Restricted Mining Purposes Claim	R.M.P.C.
Mining Lease	M.L.	Resubdivision	Resub.
Mount	Mt	Right Bank	R. Bk
Mountain	Mtn	Right of Access	R. of A
		Right of Way	R. of W.
		River	Riv. (R.)
		Road	Rd
<u>Nails:</u>			
Galv. Iron Nail	G.I. Nail		
Lead Head Nail	L.H. Nail		
Ramset Nail	Ram. Nail	Section	Sec.
Round Head Nail	R.H. Nail	Sheet	Sh.
Spring Head Nail	S.H. Nail	South	Sth (S.)
North	Nth (N.)	Special Bauxite Mining Lease	S.B.M.L.
		Special Coal Mining Lease	S.C.M.L.
		Special Gem Claim	S.G.C.
Obliterated	Obltd	Special Mining Lease	S.M.L.
Occupation	Occupn	Special Perpetual Mining Purposes Lease	S.P.M.P.L.
Old	Old	Spike	Spk.
Original	Orig. (O.)	Split	Split
Original Iron Pin	O.I.P.	Standard	Stand.
Original Peg	O.P.	Star Picket	S. Pkt
Original Permanent Mark	O.P.M.	Station	Stn
Original Reference Tree	O.R.T.	Straightened	Strghd
Original Survey Post	O.S.P.	Strainer	Strn
Overhead	O/H	Street	St
Parade	Par.	Stump	Stp
Peg	Peg (P.)	Subdivision	Sub.
Permanent	Perm.	Subtract	Subt
Permanent Mark	Perm. Mk (PM.)	Suburban	Subn
Petroleum Lease	P.L.	Surface	Surf.
Petroleum Prospecting Permit	P.P.P.	Surface Area	Surf. Area
Petroleum Well Location	P.W.L.	Surveyed	Survd
Pipeline License	P.Lic.		
Placed	Pld		
Pointer	Ptr	Tailings Area	T. A.
Portion	Por.	Telegraph Pole	T. P.
Power Pole	P.P.	Terrace	Ter.
Prospecting Area	P.A.	Traverse	Trav. (T)
Purposes	Purps		
		Underground	U/G
Railway	Rly		
Ranged Only	Rgd Only	Vacant Crown Land	V.C.L. (M)
Reads	Rds	Very Old	V. Old
Recreation	Rec.		
Registered Surveyor	Regd Surv.	Water Hole	W. H.
Reinstated	Reinstd	Water Right	W. R.
Remains	Remns	West	W.
Remarked	Remkd		
Removed	Remvd		
Renewed	Renwd		
Reset	Reset		
Reserve	Res.		
Reserved	Resd		
Residence Area	R. A.		

ABBREVIATIONS OF COMMON TREES

M.C.	Bauhinia	Bauh.	Mahogany	Mahog.
I.P.C.	Beefwood	Beefwd	Mangrove	Mgrove
sub.	Blackbutt	Bkbutt	Messmate	Mmate
Bk	Blackwood	Blackwd	Milkwood	Milkwd
of A.	Bloodwood	Bldwd	Moreton Bay Ash	M.B. Ash
of W.	Bollywood	Bollywd	Nutwood	Nutwd
(R.)	Bonewood	Bonewd	Peppermint	Pmint
c.	Bottle Brush	Bot. Brush	Pepperwood	Pepperwd
h (S.)	Bottle Tree	Bot. Tree	Poplar Gum	Pop. Gum
B.M.L.	Boxwood	Boxwd	Quandong	Qdong
C.M.L.	Brigalow	Brig.	Rosewood	Rosewd
G.C.	Cabbage Gum	Cab. Gum	Saffron Heart	Saf. Heart
M.L.	Camphorwood	Camphwd	Sandalbox	Sand box
P.M.P.L.	Candlenut	Candnt	Sandalwood	Sandwd
k.	Cheesewood	Cheesewd	Sassafras	Sasfras
lit	Coachwood	Coachwd	Satinwood	Satinwd
and.	Coolibah	Coolbh	Scrubtree	} Scrub
Pkt	Corkwood	Corkwd	Scrubwood	
n	Cottonwood	Cottonwd	Silkwood	Silkwd
rghd	Cypress Pine	Cy. Pine	Spotted Gum	Sp. Gum
nr	Dead Finish	Dd Fin.	Stringybark	Stybk
p	Fibrewood	Fibrewd	Sycamore	Symore
b.	Gum Topped Box	G.T. Box	Tallowwood	Tallowd
bt	Ironbark	Ironbk	Tulipwood	Tulipwd
bn	Ironwood	Ironwd	Turpentine	Turp.
urf.	Johnson River Hardwood	J.R. Hardwd	Whitewood	Whitewd
urf. Area	Kurrajong	Kjong	Yellowjacket	Y Jacket
rvd	Lancewood	Lancewd	Yellowwood	Yellowd

(Other tree names are generally shown in full)

STYLES

STYLES

1. **ABCDEFGHIJKLMN OPQRSTUVWXYZ**
1234567890

Subject Portion, Allotment, Reserve, Lot, Mining Tenure (M.H.L., M.H.P.L., M.L., S.M.L., S.C.M.L., S.P.M.P.L., S.G.C. etc), Easement, Island, Diagram and Sub and Resub number (if plan crowded).

2. *ABCDEFGHIJKLMN OPQRSTUVWXYZ*
1234567890 abcdefghijklmnopqrstuvwxyz

Adjoining Style of "I" above and their catalogue numbers. Adjacent Town, City, Road, Street, Railway, Channel and Drainage Area, Bay, Ocean, Sea. All Distances. All column entries, Statements and Endorsements. Corner Information. Plan Title (where applicable). Features (Gully, Bldg, 2B. IPfence etc). Read and Ranged Only Bearing. Area (right of decimal). Column Headings.

3. **ABCDEFGHIJKLMN OPQRSTUVWXYZ**
1234567890

Subject Road, Street, Lane, Pathway, Drain and Channel Area, Railway, Highway, Expressway, Freeway, Parish (in title).

4. **ABCDEFGHIJKLMN OPQRSTUVWXYZ CGS**
1234567890 abcdefghijklmnopqrstuvwxyz

Subject Bay, Sea, Ocean, River, Creek, Sub, Resub, County (in title), Area (left of decimal). Plan Title (where applicable).

5. *ABCDEFGHIJKLMN OPQRSTUVWXYZ*
1234567890 abcdefghijklmnopqrstuvwxyz

Subject Reserve Purpose, Holding, Parish on face (when applicable) — and — "Remaining" RP. description where the "initial" part is shown Vide "4" or "I" above.

6. **1234567890** — Subject Town Section **1**
Subn Sec

1234567890 — Adjoining Town Section **1**
Subn Sec

7. *1234567890 abcdefghijklmnopqrstuvwxyz*

All bearings (except Column entries, Ranged and Reads). Station Numbers. (except 'Ia' use 'Ia'.)

Note: Height and heaviness of the Styles vary accordingly for the item to be shown. All Subject property descriptions are "upright" — adjoining is "sloping".

SEE ALSO SPECIMEN PLANS AND USE IN CONJUNCTION.

SYMBOLS

ADIT
(Mines Dept plans only)



PEAK



MT
BLOCK

BINDER

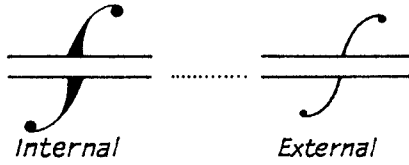

POWER LINE

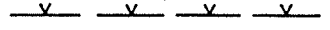

BORE • Bore

RANGE OR RIDGE.....



BROAD ARROW.....



RETAINING WALL.....



BRIDGE



ROCKY FORESHORE.....



CLIFF
OR
ESCARPMENT

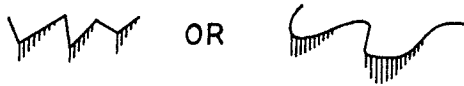

SCRUB OR
TIMBER EDGE

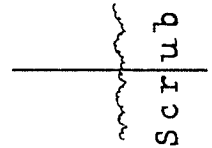

CUTTING

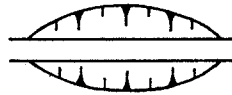

SHAFT



(MINES DEPT plans only)

DAM



SWAMP.....



EMBANKMENT
OR STEEP BANK



TANK □ Tank

FENCE

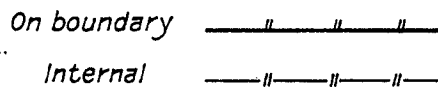

TELEPHONE AND
TELEGRAPH LINE



GULLY

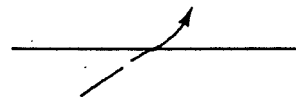

TRACK



MANGROVES

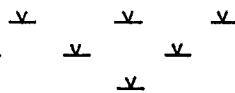

WEIR.....



MINING DISTRICT.....



WELL • Well

(Mines Dept plans only)

MINING FIELD.....



WINDMILL.....



OBSERVATION STATION.....



DEPARTMENTAL REQUIREMENTS

By "Requirements" is meant the method to be followed on a plan of survey to make effective the action as approved by the relative authority and in accordance with the "Act" or "Acts" under which the authority operates.

**REQUIREMENTS
OF THE
DEPARTMENT
OF MAPPING
AND SURVEYING**

Main actions that occur under the provisions of the "Land Acts", the "Acquisition of Land Act" and other Acts, are as follows:

- (1) Subdivision of Crown or Leasehold land
- (2) Additions and Excisions affecting Leasehold and Freehold land.
(This includes Resumptions and Road Actions)
- (3) Easements
- (4) Remarkings etc.

I. SUBDIVISION OF CROWN OR LEASEHOLD LAND

Vacant Crown Land when subdivided will be described as:-

- (a) Country Land Portions
- (b) Town or City land Allotments of a Section

Portions will be of a Parish, a County and a Land Agents District.

e.g. Portion 127, Parish of Bulimba, County of Stanley, L.A.D. of Brisbane.

Allotments will be of a Section, a Town or City, a Parish, a County and a L.A.D.

e.g. Allot 4 of Section 25 Town of Esk, Parish of Esk, County of Cavendish, L.A.D. of Ipswich.

Further subdivision will be as follows:-

Portions Existing Portion number is retained for one block and new number or numbers allocated for other block or blocks. The allocation of Portion numbers is the job of the Charting Section, Department of Mapping and Surveying. e.g. Portion 21 is subdivided into three blocks Portion 21 and Portions 272 and 273.

Note: A continuous new road in a block cannot be broken. It must be completed in an uninterrupted manner, to scale, somewhere on plan. Diagrams thereof may be drawn as necessary either on main plan or subsidiary sheets.

Allotment of a Section Existing Allotment number is retained for one block and new number or numbers allocated for other block or blocks. Allocation of these numbers is again the sole responsibility of the Charting Section. e.g. Allotment 8 of Section 24, Town of Ayr is subdivided into three blocks Allots 8, 13 and 14 of Sec 24, Town of Ayr.

2. ADDITIONS AND EXCISIONS

(Affecting both Freehold and Leasehold land)

ADDITIONS

The following procedures apply equally to Freehold and Leasehold land. It is to be noted that any addition to an existing freehold block is being implemented under the provisions of Section 9 of the Land Acts and requires a plan to be lodged in the Department of Mapping and Surveying.

Additions have been treated under the headings:-

- (a) Addition of Crown Land.
- (b) Addition of Road Closure to
 - (i) Portion or Allotment
 - (ii) Titles Office Description (pre-shortened descriptions)
 - (iii) Amalgamated Title
 - (iv) Railway Property See Excisions .. (c) (iv)
- (c) Additions affecting Titles Office Shortened Descriptions (Lots).

(a) ADDITION OF CROWN LAND

Plan Requirements: Complete surround of the affected block inclusive of the area being added.
 The title will be the existing cadastral description.
 On face will be shown "Area to be added" with qualifying station numbers and area.

Example A

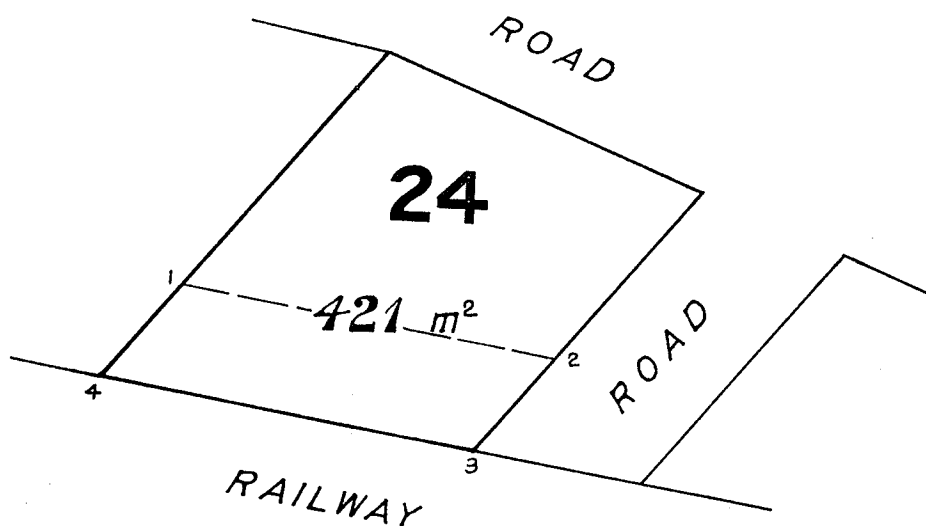

Area to be added
 (1-2-3-4)... **121 m²**

Title.....Portion **24**

(b) ADDITION OF ROAD CLOSURE

Plan Requirements: Complete surround of the affected block inclusive of the area of road being added.
The title will be the existing cadastral description.
On face will be shown "Road to be closed" with qualifying station numbers and area.

(i) Portion or Allotment (Freehold and Leasehold)
See previous example Example A.
Substitute "Road to be closed" for "Area to be added"

(ii) Titles Office Description (Pre-shortened Descriptions)
e.g. Resub 6 of Sub 4 of Portion 14

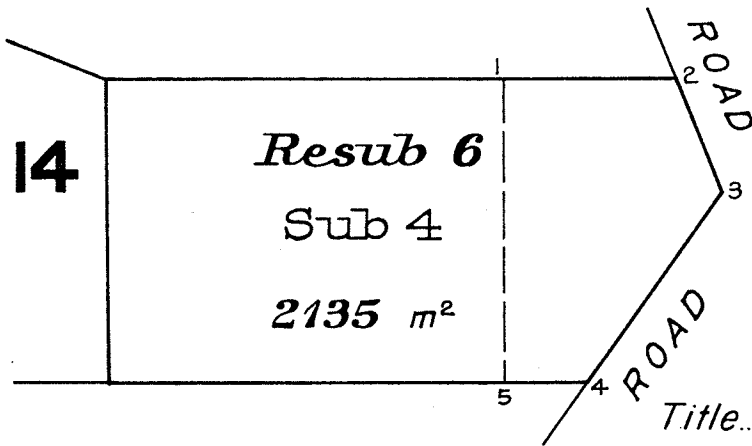

Example B

Road to be closed
(1-2-4-5).... **721 m²**

Title..... Resub 6 of Sub 4 of Por 14

(iii) Amalgamated Title
e.g. Subs 1 to 3 of Portion 471

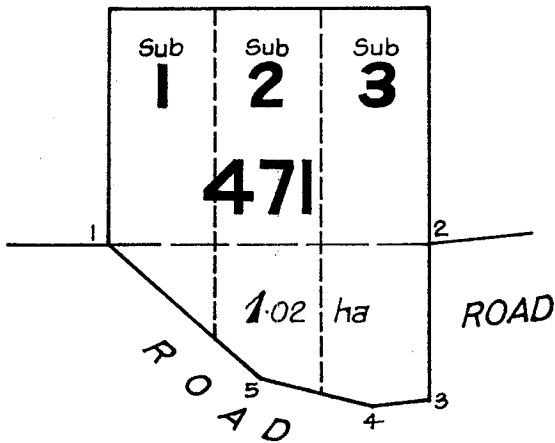

Example C

Road to be closed
(1-2-3).... **4211 m²**

Title..... Subs 1 to 3 of Por 471

(iv) Railway Property
see Excisions (c) (iv)

(c) ADDITIONS AFFECTING T/O SHORTENED DESCRIPTIONS (LOTS)

All additions as covered have been situations where existing cadastral descriptions have been retained. An exception to this rule comes into effect when an addition is **being** made to a freehold block with a shortened description (Lot 1 on R.P. 12345). For any addition to a block so described, a Portion number (or Allot of a Section) has to be allocated - allocation again the prerogative of the Charting Section, Department of Mapping and Surveying.

Plan Requirements: Complete surround of the affected block inclusive of the area being added.

The title will be of "Portion"
On face will be shown:-

- (i) for an addition of Crown Land
"Area to be added to Lot ... on R.P." with qualifying station numbers and area.
- (ii) for an addition of closed road
"Road to be closed and added to Lot on R.P." with qualifying station numbers and area.

Eg... Road to be closed and added to
Lot 4 on RP.120278 (Orig Por 57)
(1-3-4-6)..... **213** m²

EXCISIONS

Excisions have been treated under the headings:-

- (a) Excision from Leasehold (or Crown Reserve) for addition to adjoining leasehold.
- (b) Excision for Road (M.R.D. Resumption)
From Leasehold and Freehold.
For Freehold
 - (i) Road Resumption only
 - (ii) Criss crossing old and new roads
 - (iii) Severances
 - (iv) Easements
 - (v) Resumed area held under C/T.
 - (vi) Resumption from Commonwealth
- (c) Excision for Railway Purposes.
 - (i) From Leasehold
 - (ii) From Freehold
 - (iii) From leasehold and freehold intermingling
 - (iv) From road.
- (d) Resumption by other Government Department.

Note: A continuous new road in a block cannot be broken. It must be completed in an uninterrupted manner, to scale, somewhere on plan. Diagrams thereof may be drawn as necessary either on main plan or on subsidiary sheets.

(a) EXCISION FROM LEASEHOLD (or Crown Reserve)- For addition to adjoining Leasehold

Apart from the various Resumptions and Road Actions, this is in general the only other excision that affects Leasehold. It is to be remembered that an excision to create a "Portion" is classified as a Subdivision.

Plan Requirements: Both affected blocks will be completed on the plan of survey if possible. The title will be of Portions (or allots) On face will be shown .. "Area to be excised from Por ..." with qualifying station numbers and area.

See 'Example D' below.

Example D

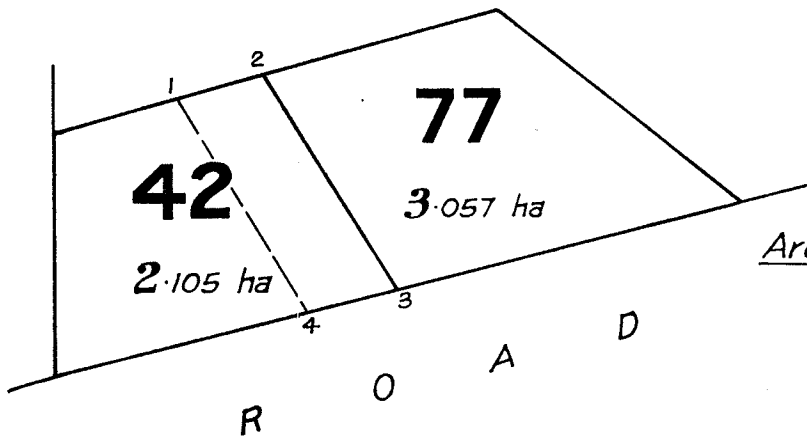

Area to be excised from Por 77 (1-2-3-4)... 7112 m²

Title.....Portions 42 & 77

(b) EXCISION FOR ROAD (MRD Resumption)

FROM LEASEHOLD

Plan Requirements: Affected block will be completed on the plan of survey. The title will be of Portion ... (or Allot, Reserve etc.) On face will be shown "Area of New Road" with qualifying station numbers and area.

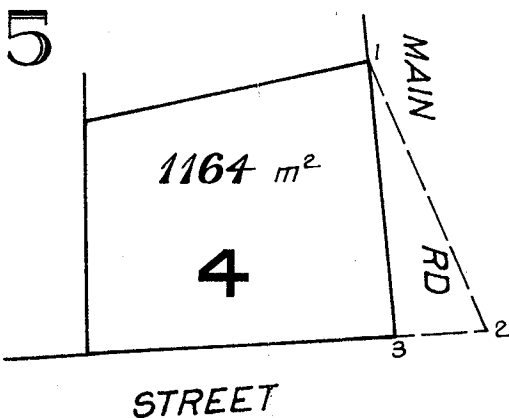

Example E

Area of New Road (1-2-3)... 212 m²

Title.....Allot 4 of Sec 5

For criss crossing old and new road, severances and easements .. See "Freehold" (ii), (iii) and (iv) for plan treatment.

FROM FREEHOLD

Resumption by M.R.D.

M.R.D. takes all its land by proclamation on an 'about' area. The majority of adjustments are effected under Section 9 of the Land Acts. This is to enable title adjustment to include surplus road areas, the utilisation of Road Reservations and the adjustment of severances. Adjustments in surveys can also be effected at the same time. There are no opening and closing notices published for M.R.D. adjustments involving Main Roads in freeholds. Should a severance be excluded from one Title for inclusion in another title, adjustment is effected under Section 9 and the severances are opened and closed as road.

When Section 9 is not used and the proclamation is registered (usually because of failure to reach a settlement or some factor which prohibits the execution of a surrender) the following is the procedure:-

After the proclamation on the "about" area is issued, the Dept. of Mapping and Surveying causes a survey of the road excision to be made. For the purpose of registering the proclamation and after request by the M.R.D., the D.M.S. prepares a T/O plan based on the D.M.S. plan of survey. This T/O plan being forwarded to the M.R.D. by Roads Section (Dept. of Lands). M.R.D. then publishes an amending proclamation based on the T/O plan i.e. showing a Lot number and surveyed area. The plan is signed by the Commissioner of Main Roads as Constructing Authority.

(i) Road Resumption only

Pertinent road action only is shown on plan.

Title will be ... "Road in" ...

On face will be shown the "Area of new road" with qualifying station numbers and area.

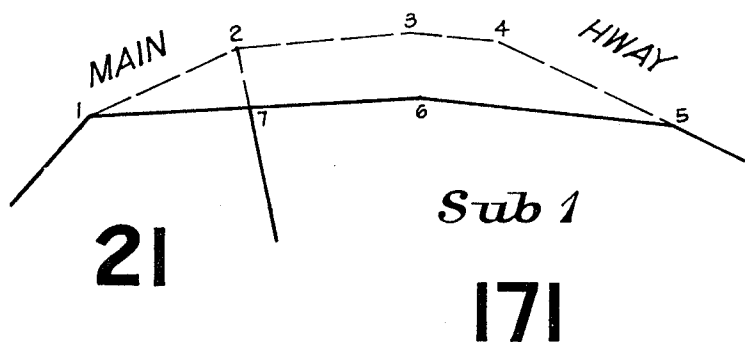

Example F

Area of New Road
 Por 21(1-2-7)... **211 m²**
 Sub 1(2-5-7)... **1712 m²**

Title.....Road in Por 21 and Sub 1 of Por 171

(ii) Criss Crossing Old and New Roads

When these have no connections except at terminal points, the following procedure applies:-

The affected block will be completed on face of plan.

On face will be shown "Area of New Road" and "Area of Old Road", both with qualifying station numbers and area.

Example G

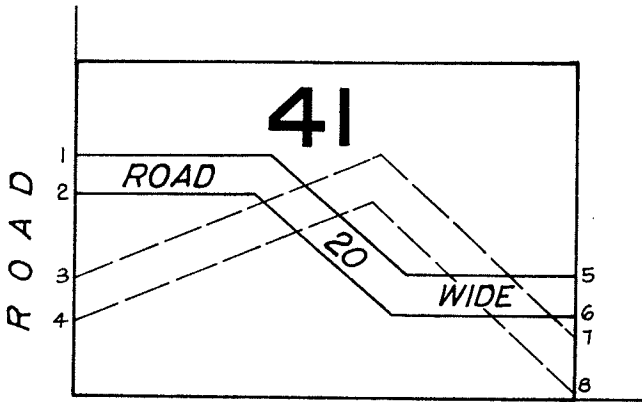

Area of New Road
 (1-5-6-2)...1.027 ha
Area of Old Road
 (3-7-8-4)...1.156 ha

Title.....Portion 41

(iii) Severances

When small severances are involved which are to be adjusted under the provisions of Section 9, the following will apply:-

No reference to severance will be shown in the title.
 On face will be shown "Area of Severance" with qualifying Station numbers and area.

See Example H.

(iv) Easements

When these are affected by a resumption for road, the following is adopted:-

No reference to easement is shown in title.
 On face will be shown "Area excised from Easement" with qualifying station numbers and area.

Example H

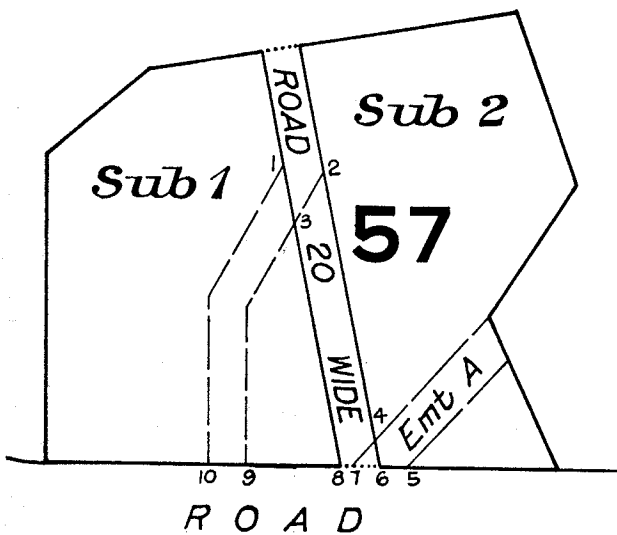

Area of New Road
 Sub 2 (2-6-8-3)...1.135 ha
Road to be closed
 Sub 1 (1-3-9-10)...1.021 ha
Area of Severance
 (3-8-9)...1.235 ha
Area excised from Emt A
 (7-4-6)...121 m²

Title.....Subs 1 & 2 of Por 57

(v) Resumed Area held under C/T

When the area resumed is not being used for road but is to be held under C/T by the M.R.D. for future road purposes, the procedure to be adopted

is:-

- (a) If the survey is of the resumption to be held in fee-simple only - a normal T/O plan of subdivision (with marks) is drawn.
- (b) If, however, this resumption in fee-simple is part only of a M.R.D. survey involving road resumptions:-

A normal D.M.S. plan of survey is drawn covering all actions, (and a follow up compiled T/O plan of the resumption involving the fee-simple is prepared). The title of the Plan will be "Road in" as normal, with the area being taken in fee-simple shown on face with all black boundaries and lot numbers as per T/O plan.

(vi) Resumption from Commonwealth

It should be noted that where MRD resumptions affect Commonwealth Freehold, title adjustment may be by way of Section 9 of the Land Acts or by dedication of the road area on a Titles Office plan of survey. Action is dependent on whether the land was acquired by compulsory process or purchase by agreement. Correct procedure will be subject to reference to the Department of Administrative Services.

Note: For a constructing authority other than M.R.D. making a resumption for road purposes, plan action will be similar for all instances where the instruction is issued by the D.M.S. When a private instruction is the motivating force, plan requirements will be:-

- (a) For leasehold land - actions similar to existing ones covered.
- (b) For freehold land - T/O plan of survey only.

In some instances it may be necessary to change the wording "Area of New Road" to "Road to be opened" if this is indicative of the action involved.

(c) EXCISION FOR RAILWAY PURPOSES (Railway Resumption)

(i) Leasehold

Plan Requirements: Affected block will be completed on plan of survey. Title will be of Portion
On face will be shown "Area Resumed" or "Area to be resumed" (depending on gazettal) with qualifying station numbers and area.

(ii) Freehold

Resumption for Railways purposes only:

This entails a normal T/O plan of survey (i.e. a subdivision)

Resumption for railway and road

Again a normal T/O plan of survey - giving area to be taken for road a "Lot" number.

(iii) Leasehold and Freehold intermingling

If surveyed as one action, the easiest solution is to show everything on a D.M.S. plan of survey with a follow up compiled T/O plan of the affected freehold.

D.M.S. Plan Requirements:

The title will be "Railway Resumption from"
 On face will be shown "Area Resumed" or "Area to be Resumed"
 (depending on gazettal) with qualifying station numbers and area.

(iv) Addition to Railway Property of Road Closure

Plan Requirements: The title will be "Area required for Railway from Road through .. (or adjoining .. etc)"
 On face will be shown "Area Required" with qualifying station numbers and area.

NOTE: For Railway Resumptions, the wording as given above for "title" and "on face" usage may be:-

- (a) used in its entirety
- OR (b) variations may be introduced provided the meaning and action are clearly indicated.

Railway Resumptions Example

Example J

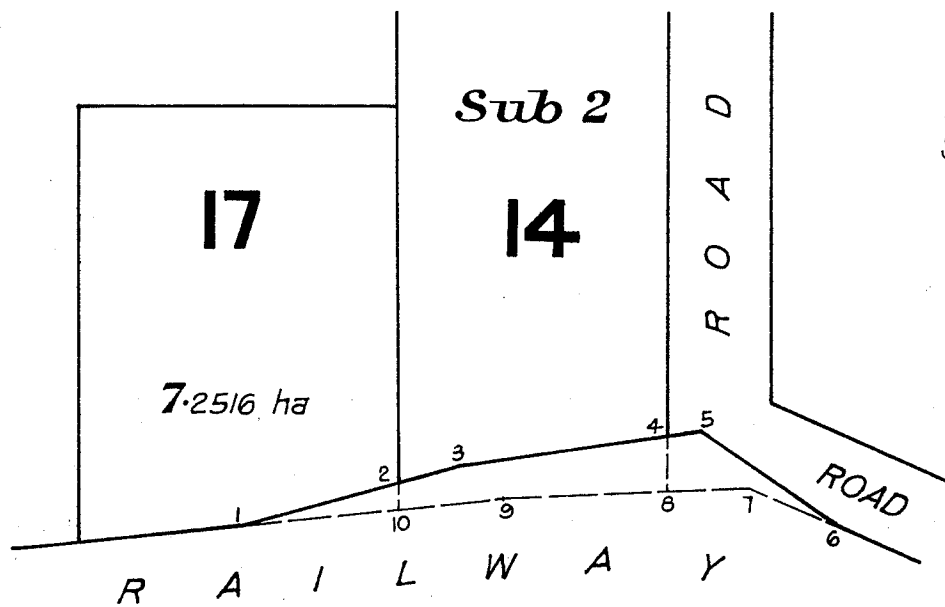

Area Resumed
 Por 17(1-2-10)...**2131 m²**
 Sub 2(2-4-8-10)...**4217 m²**

Area Required
 (4-6-8)...**2315 m²**

Title.....Portion 17, Railway Resumption from
 Sub 2 of Por 14 and area required
 from road adjoining

Alternative: Por 17 and Railway Resumption from Sub 2 of Por 14
 and road adjoining

(d) RESUMPTIONS BY OTHER GOVERNMENT DEPARTMENTS

i.e.... other than MRD and Railways

These, in general, take the format of a resumption from freehold in order to create a Lease (or Reserve) or to add to an existing Lease (or Reserve). This action may be covered at the plan stage by either of two ways.

- (1) A D.M.S. plan of survey combined with a compiled T/O plan.

D.M.S. Plan Requirement: Plan will show the completed action,
i.e. the Portion created or being added to.

- (a) For the portion being created:
Title will be of Portion
No endorsements on face will be necessary.

- (b) For the plan with an addition to an existing portion.
Title will be of Portion ...
On face will be shown "Area to be excised from Resub 2 of Sub 3 of Portion 72" etc, with qualifying station numbers and area.

NOTE that the full cadastral description of the block being resumed from is given in the endorsement describing area resumed.

Compiled T/O Plan Requirement:

This plan is simply a subdivision of the affected block and will show:-

- Lot 1 as the balance being retained by owner.
Lot 2 as the area being resumed.

Note: The Titles Office will still accept a compiled plan when signed by a Constructing Authority i.e. a resumption under the "Acquisition of Land Act of 1967"

- (2) A T/O Plan of Survey and a compiled D.M.S. plan.

The T/O Plan of survey will be a normal plan of subdivision, and will show:

- Lot 1 as the balance being retained by owner.
Lot 2 as the area being resumed.

The D.M.S. compiled plan will be either:

- (a) The new portion being created
OR (b) An existing portion being adjusted (addition of Lot 2)
An endorsement on the plan will signify to this effect.

Example K

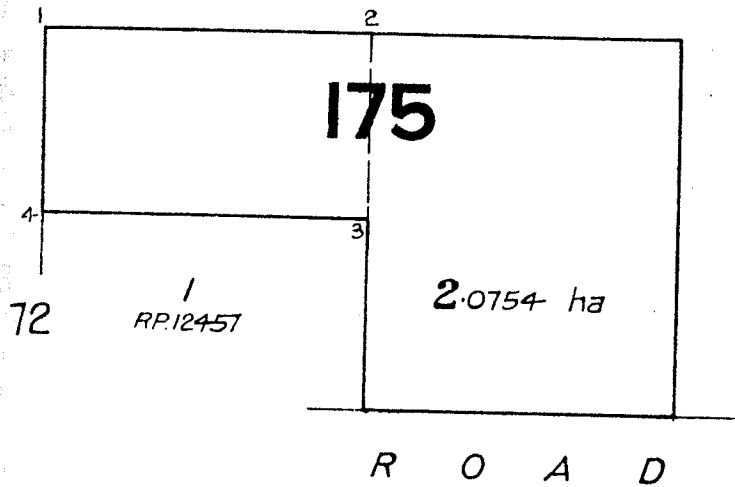

Area to be excised from
Resub 2 of Sub 3 of Por 72
(1-2-3-4).... 7112 m²
(Lot 2 on RP.12457)

Title.....Portion 175

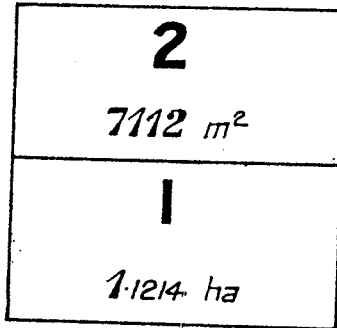

Title.....Lots 1 & 2

Cancelling Resub 2 on RP.10146

PLAN...12457

3. EASEMENTS

"NOT TO SCALE" DIAGRAM FORMAT

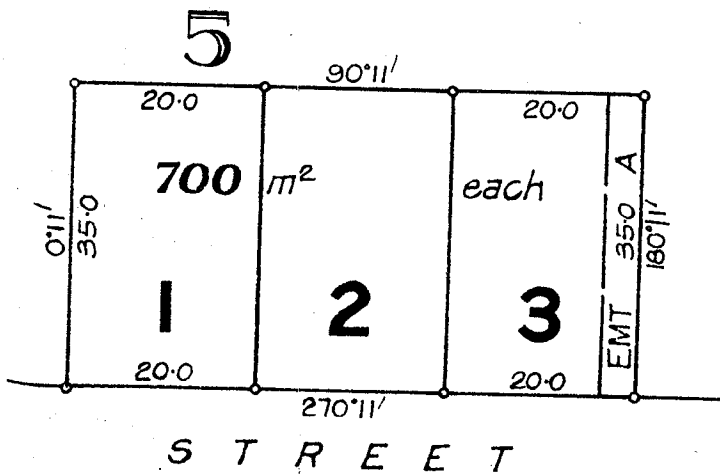

Example L

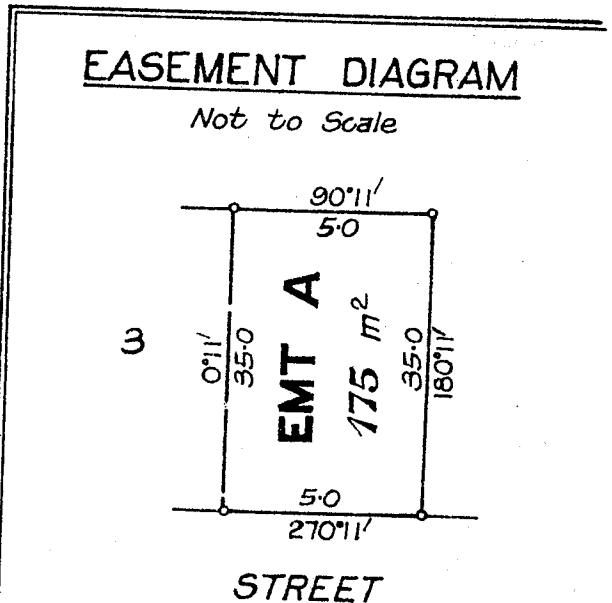

Allots 1 to 3 (and Emt A
in Allot 3) of Sec 5

4. RE-MARKING (AND IDENTIFICATION SURVEYS)

This is divided into two cases where -

- (a) Survey records are provided
- (b) Survey records are not provided

(a) Survey Records provided:

- (i) When the remarking effected is of a nature that:-

Measured distances agree with original,
No new reference marks are placed,
Occupation is not in evidence etc.,
New pegs placed are in agreement with original.

No new plan is required - a suitable endorsement is shown on existing plan i.e. For remarking of Allots 4-7 of Sec 2 see Inst.78K1/314

T.R. Burp 5.2.78

- (ii) When the remarking is such that:-

Measured distances are in disagreement with original,
New reference marks are placed,
Occupation is referenced etc.,

A new plan is required. This plan will be titled "Resurvey of". Area need not be shown unless required for correction of title.

(b) Survey Records not provided:

In these instances no plan can be drawn, but an endorsement as quoted in (a) (i) may be utilised.

If circumstances are warranted, a sketch may be drawn and kept on the relative file.

plans
survey
plan.

ALTE
Before
entail
Once
cross
which

OUN
coun
ocks
rying
re
NAME

ADDITIONAL REQUISITES

Plans lodged in the Department of Mapping and Surveying should be drawn with the survey information (Reference Marks etc) tabulated as per the DMS Specimen plan.

ALTERATIONS AND ADDITIONS

Before plan is registered any amendments necessary will be done by "erasure" as required. This will entail return of plan to surveyor or drafting contractor as necessary.

Once a plan is registered and charted on office map, any alterations will have to be by "crossing out" etc. In these instances plan will have to be endorsed with a statement, a format of which is illustrated.

Alterations to vide

Supervising Computer
Date

BOUNDARY REINSTATEMENT

In country surveys (conversions of tenure to freehold, Forestry Dept resumptions etc) where the checks are being completed on the plan utilising "original information", there are times when varying meridian differences occur between the new survey and the previous plan. The reinstated bearing determined by the surveyor is to be adopted at all times.

EXAMPLE :

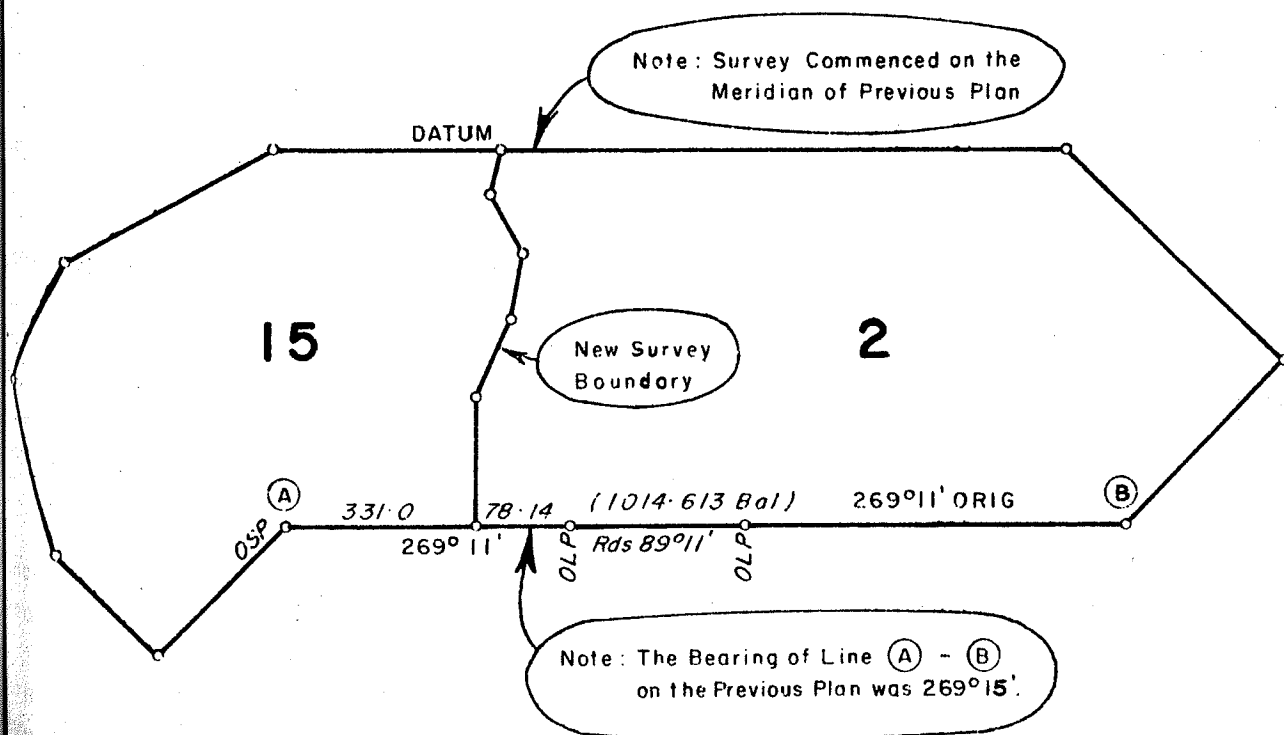

COMPILED PLANS

While the standard practice is for plans without field survey to be drawn in the Department of Mapping and Surveying, there are instances when such compilation will be undertaken by other areas subject to prior approval by the Surveyor-General. Such plans must be drawn in conformity with the general format of the Detailed Drafting Standards segment of this manual, and will be endorsed with the certificate as per Form 13 - Part B of the Surveyors Regulations 1978.

Plan must also be endorsed with a statement indicating the source of information utilised in the compilation. This may be incorporated in the certificate as follows:-

.....and that the plan is accurate, and is compiled from Cwl.1300, Cwl.1415 and R.P.1295.

- (a) With the existing plan form in use, "SURVEY PLAN" in the title block will have to be altered to "PLAN"
- (b) The existence of registered easements will be covered by endorsement only.

e.g. Por 57 is subject to
Easement A on Sl.2345

- (c) For actions where:-

- (i) A parcel of freehold land is surrendered to the Crown. (i.e. for Reserve Purposes)
- (ii) Road closure (or opening under Section 9) affects a Lot.

A suitable endorsement such as follows has to be shown on plan:-

Por 107 includes former
Lot 1 on R.P. 12476 (orig Por 9)
(Area 31.23 ha)

It has to be emphasised that plans compiled for the purpose of lease or deed issue must be drawn to a standard capable of taking a reduction of up to 0.5 diameters, for reproducing direct on to the document.

CONVERSIONS

Imperial to Metric

- (a) All distance conversions will be to 3 decimal places.

- (b) Area conversions :

In excess of 1 hectare convert to 3 decimals.

Less than 1 hectare convert to 4 decimals. (i.e.nearest m²)

DESCRIPTION OF COUNTRY

Positions of creeks, gullies, edges of scrub, timber, swamps etc as determined by actual measurement, are to be shown in such a manner as not to interfere with lettering on plan or other information. See 'SYMBOLS'— Page 37.

A description of the character of the country should be neatly shown across the face of plan as follows :-

Thickly timbered with Gum Box Bloodwood and Tea-tree
Thick and continuous grass
Brown stony soil

This description is to be restricted to the area of survey contained in the survey records, and an "overall" format is to be adopted whenever possible, as illustrated on specimen plans.

Description of country may, however, be shown in tabloid form if clarity of plan would be impaired by showing on face.

FENCE POST REFERENCING

Fence posts located along surveyed lines will be referenced by the cardinal points N,S,E,W etc.

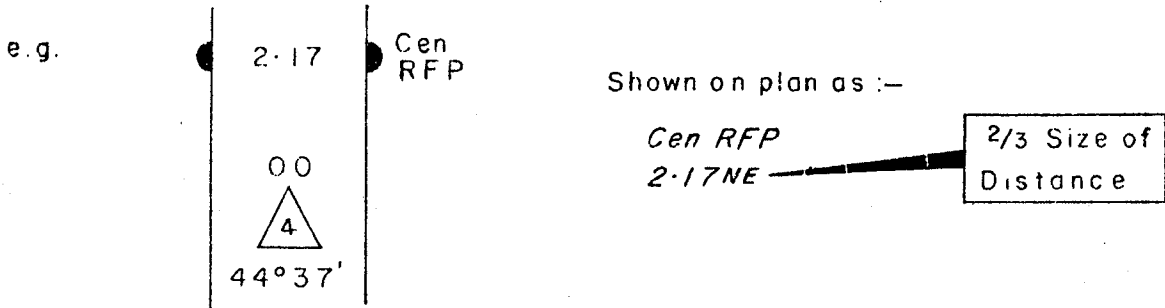

Fence posts off the surveyed line and referenced by bearing and distance, will be shown accordingly. i.e. Cen RFP 126°47', 3.26

Both above cases apply to fence posts close to station (i.e. within approx 10 metres) in general, fence posts outside this limit will be shown on plan by plot only.

INDUSTRIAL ESTATES

The following procedures will apply on plans related to the survey of progressive development of these estates.

- (1) Descriptions of adjoining areas which will be cancelled before the plan is acted on are not to be shown.
- (2) Boundaries of designed areas which adjoin subject land will not be shown.
- (3) Designed roads will not be shown except for dedication purposes to give access to subject blocks.
- (4) The Estate name is shown in upright capitals at the bottom of the plan.

LEASES (SUB-LEASES, CROWN OR LEASEHOLD LAND)

Similar treatment as per Easements.

MINIMUM STANDARD WIDTHS

Under the Local Government Act, roads are classified by the Local Authority in relation to the use which they are required to serve.

There shall be a minimum standard width for each class of road :-

- | | |
|----------------------------|-------------|
| (a) For a principal road | : 25 metres |
| (b) For a secondary road | : 20 " |
| (c) For a residential road | : 20 " |
| (d) For a lane | : 7 " |
| (e) For a pathway | : 3.6 " |

Under the provisions of this Act, however, a Local Authority may in the case of a secondary road, residential road or a lane, where it deems proper in the circumstances, permit the opening of such of less than the standard minimum width.

UNSURVEYED ROADS ALONG BOUNDARIES

This refers to an unsurveyed road along and within the boundary of a block as in the following diagram. The term "unsurveyed" here means "no secants laid in on the ground".

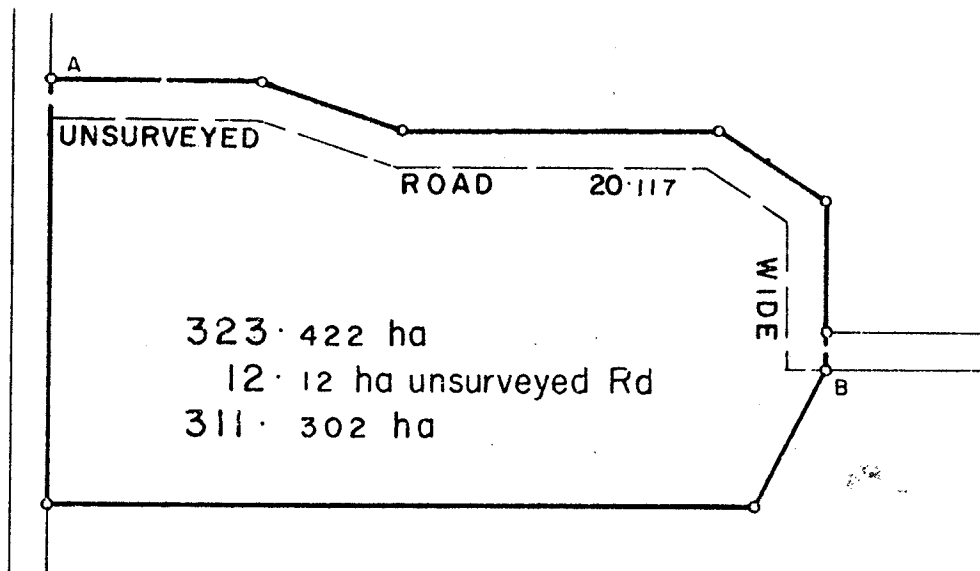

Boundary of block will be by surveyed lines A to B. i.e. boundary will be from "monument to monument."

Area of road will be treated as illustrated.

Road will be described as "Unsurveyed Road 20.117 Wide."

WATERCOURSES – EROSION AND ACCRETION

For Resumption Surveys (MRD, Rlys etc) which record noticeable differences in the position of watercourse banks from the original, the plan treatment will be as follows:—

EROSION

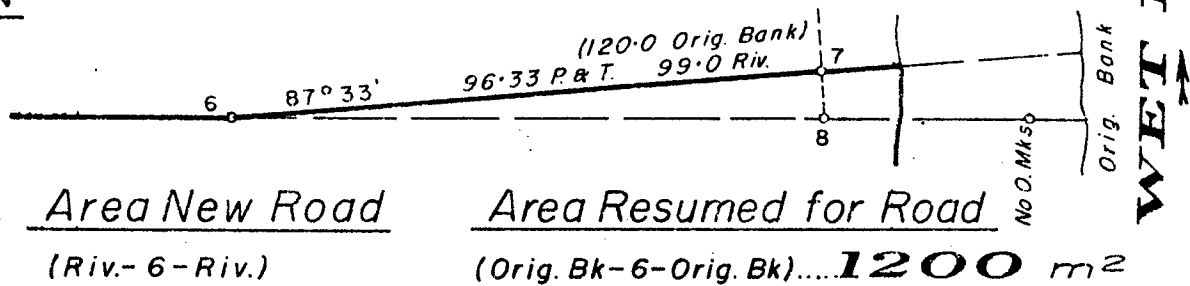

ACCRETION

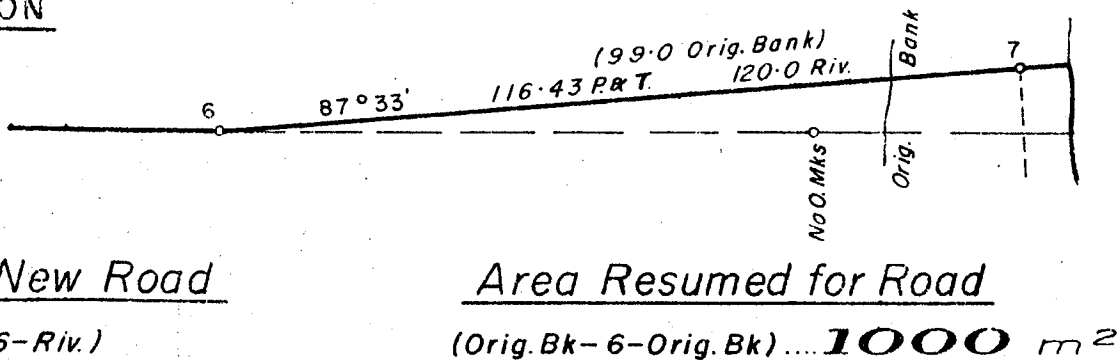

REQUIREMENTS
OF THE
DEPARTMENT
OF MINES

ACCESS TO MINING LEASES See "RIGHT OF ACCESS" and "RIGHT OF WAY"

ADDITIONS TO HOMESTEADS See "MINER'S HOMESTEAD LEASE (c)"

ADDITIONS TO MINING LEASES See "MINING LEASE (g)"

ALTERATIONS and ADDITIONS

- (a) Before plan is "passed" any amendments necessary will be done by "erasure" as required. This will entail return of plan to surveyor or drafting contractor as required.
- (b) Once a plan is "passed" and charted on office map, any alterations will be made in red by "crossing out" etc. In these instances the plan will be endorsed (in red) with the following amendment certificate.

Alterations to vide

.....
Supervising Examiner.

Date

AMALGAMATION OF HOMESTEADS See "MINERS HOMESTEAD LEASE (e)"

APPLICATION POSTS See "MINING LEASE (c)"

AREAS TO BE SURRENDERED FOR ROAD See "MINER'S HOMESTEAD LEASE (g)"

AUTHORITIES TO PROSPECT (A's to P)

- (a) On plans showing a point, line or area of an A to P, the sub-block corners of which are described by geographic co-ordinates, the datum of the co-ordinates should be stated on the face of the plan as follows:—

Geographic Co-ordinates
on Australian Geodetic Datum

- (b) All bearings should be referred to the True Meridian.
- (c) When bearings are given, both forward and reverse azimuths must be shown where applicable.
- (d) If geodetic points are not available in the district at the time of survey, and an A to P corner is determined by astronomical observations, a certificate signed by the holder and all adjoining A to P holders, agreeing to accept the boundaries as located, must appear on the plan.
- (e) Plans of A to P surveys should show connections to cadastral boundaries and comparison of meridians where practicable.

BACKGROUND TENURES See "OTHER TENURES"

CLAIMS AND AREAS

- (a) Claims and Areas as defined by the Mining Act are registered by the Mining Warden and generally are not surveyed. Where surveyed, show as for Mining Lease requirements.
- (b) See "RESTRICTED MINING PURPOSES CLAIMS", "SPECIAL GEM CLAIMS" and "SPECIFIC AREAS".

COAL MINING LEASE See "MINING LEASE"

COMPILED PLANS (i.e. Plans without Field Survey)

- (a) Prior approval of the Senior Staff Surveyor must be obtained for all compiled plans
- (b) Information may be compiled from examined Mines Dept., Office of the Surveyor General and Titles Office plans only. Dimensions are not qualified by the word "ORIG.". Stations Nos. or letters are shown only when required to describe specific actions (i.e. Additions etc.)
- (c) If a compiled surround closes within the allowable limits of error a calculated area may be used. If not, a compiled area is to be used and labeled where applicable "bal." or "by addn."

COMPILED PLANS (CONT)**(d) Compiled Plans involving MHPL's**

Compiled plans involving MHPL's must bear the following statement :-

*Copied and compiled from Plan No.....
in the Mines Department, Brisbane.*

Substitute or add "Office of the Surveyor General" or "Titles Office" where applicable.

(e) Compiled Plans involving ML's

(i) Compiled plans involving ML's must bear the following certificate :-

*I certify that this plan has been correctly copied
and compiled from Plan No..... in the
Mines Department, Brisbane, and that the Datum
Post was found by inspection to agree with the
Lease Application as shown hereon.*

.....
Licensed Surveyor

Substitute or add "Office of the Surveyor General" or "Titles Office" where applicable.

(ii) Compiled plans of ML's must show "Datum Post" on the face of the plan, with a connection from the appropriate lease corner tabulated as per the reference shown on the application. An accurately measured connection is not required.

(f) For private plans the "Surveyed By" box should be amended to "COMPILED BY"

(g) Plans compiled by the Department should be labeled "Office Compilation" in the "Surveyed By" box.

(h) The title of the plan is the same as if it were a survey.

CONDITIONAL SURRENDER See "MINER'S HOMESTEAD LEASE" and "MINING LEASE"

CROWN LAND See MINING ACT, 1968-1976, Sec. 7

DATUM POST See "MINING LEASE (d)"

DEPTH RESTRICTIONS See "MINING LEASE (e)"

DESIGN PLANS

Plan requirements for subdivisional designs of Mines Department Estates for auction as MHPL's are similar to those for survey plans, except that the unsurveyed design boundaries are drawn in full black lines, circles and station numbers at corners are omitted, and the title should be headed:—

DESIGN OF

EXCHANGES BETWEEN HOMESTEADS See "MINER'S HOMESTEAD LEASE (d)"

EXCISIONS FROM HOMESTEADS See "MINER'S HOMESTEAD LEASE (c)"

GOLD FIELD HOMESTEAD (G.F.H.)

Now renamed Miner's Homestead Lease (M.H.L.)

HOMESTEAD LEASE See "MINER'S HOMESTEAD LEASE"

IDENTIFICATION SURVEY

- (a) Plan requirements for boundary identification surveys of all or part of any existing mining tenement are the same as the plan requirements for a survey of that tenement; except that the plan title should be headed: —

IDENTIFICATION SURVEY OF.....

- (b) Identification surveys to be drawn on Mines Dept. plan forms

LEASES See "MINER'S HOMESTEAD LEASE", "MINING LEASE", "SPECIAL PERPETUAL MINING PURPOSES LEASE" and "SUBLEASE"

LOCALITY

The "Locality" Box on the Mines Dept. plan form should state the name of the Suburb or District, or describe the situation of the survey in relation to a permanent feature shown on a Mines Dept. Approved Map.

LOTS See "MINER'S HOMESTEAD LEASÉ (f)"

MINER'S HOMESTEAD LEASE (M.H.L.) & MINER'S HOMESTEAD PERPETUAL LEASE (M.H.P.L.)

- (a) **New MHPL over Undescribed Crown Land**

When a new MHPL occupies undescribed crown land the lease number becomes the description of the block and is shown on the face and in the title.

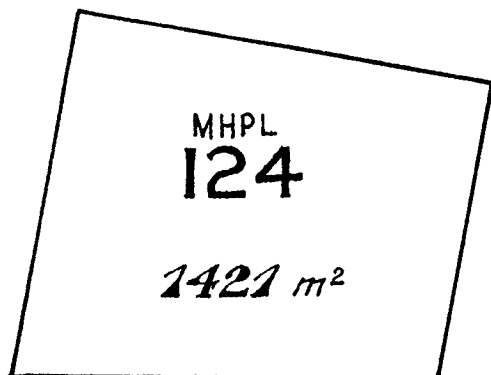

Title **MHPL 124**

- (b) **New MHPL over Described Crown Land (Allot. of a Section or Portion)**

- (i) When a new MHPL occupies the whole of an existing portion or allotment of a section show the original description on the face and in the title. Show the MHPL number in a tenure table only.

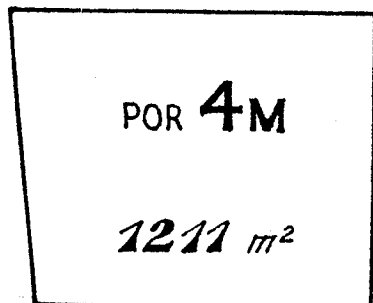

TENURE	
PORTION	MHPL
4M	5771

Title **POR. 4M**

MINER'S HOMESTEAD LEASE (CONT.)

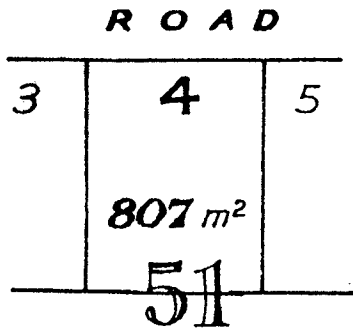

TENURE	
SECTION 51	
ALLOT.	MHPL
4	6825

Title **ALLOT 4 OF SEC 51**

(ii) When a new MHPL occupies other than exactly one existing portion or allotment of a section delete all reference to the portion(s) or allotment(s) affected.

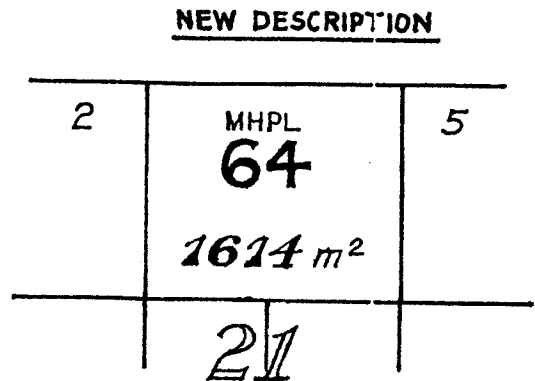
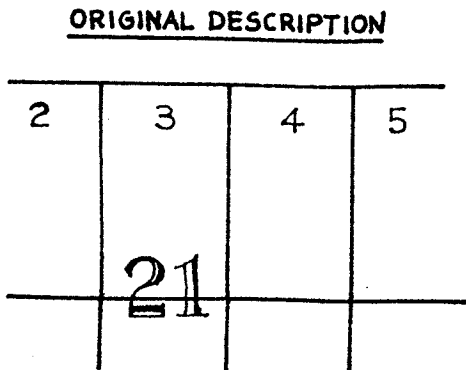

Title **MHPL 64**

(c) Additions to & Excisions from Homesteads

(i) The plan should show a complete surround of the affected block in its new format together with complete dimensions of each severance being dealt with. Cancelled boundaries are to be utilized where necessary. A statement describing each severance being dealt with is to be shown on the face of the plan. The title describes the final action only.

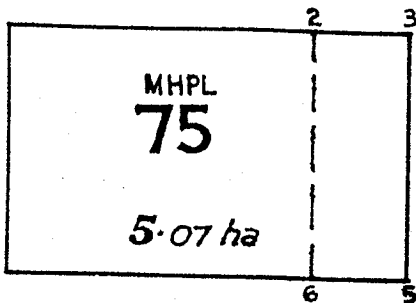

AREA TO BE ADDED TO MHPL 75

(2-3-5-6)..... 1.02 ha

Title **MHPL 75**

MINER'S HOMESTEAD LEASE (CONT.)

- (ii) The general term "excision" should be used only in conjunction with an addition. If the excision is the only action it should be called either a surrender or a resumption, which are particular types of excisions.
- (iii) An excision of an area from one Homestead and its addition to an adjoining Homestead may take place as one action.

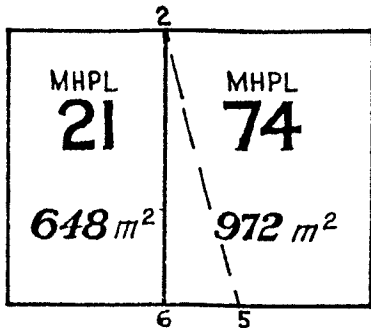

AREA TO BE EXCISED FROM MHPL 21
AND ADDED TO MHPL 74

(2-5-6).....162 m²

Title..... **MHPL's 21 & 74**

- (iv) When two or more areas are being "swapped" between adjoining Homesteads the action of excision and addition is known as an exchange (See (d) below).
- (v) In simple cases of an addition and excision with a subsequent subdivision, both actions may be shown on the one plan form. Separate diagrams and complete dimensions must be shown for each action. The areas to be excised and added must be clearly described by statement on the plan. The title of the plan describes the final action only. Cancelled boundaries are shown on the diagram of the first action only.
- (vi) See "UNDESCRIBED BALANCE"

(d) Exchanges between Homesteads

- (i) Two Homestead Leases cannot transfer small areas by subdivision. An **exchange** has to be effected. Complete dimensions of all blocks (old and new) and exchange areas are to be shown on the plan.

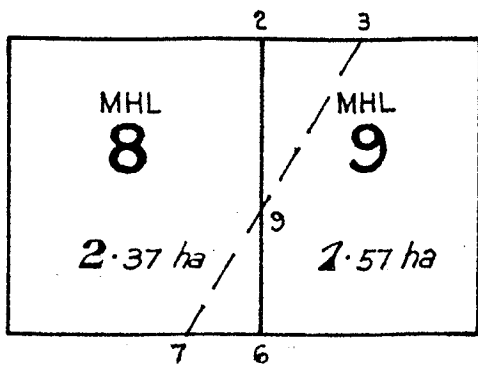

AREA TO BE EXCISED FROM MHL 9
AND ADDED TO MHL 8

(6-7-9).....775 m²

AREA TO BE EXCISED FROM MHL 8
AND ADDED TO MHL 9

(2-3-9).....1164 m²

Title..... **MHL's 8 & 9**

- (ii) In simple cases, an exchange and subsequent subdivision may be shown on one plan. Separate diagrams and complete dimensions must be shown for each action. The exchange action must be clearly described by statement on the plan. The title of the plan describes the final action only. Cancelled boundaries are shown on the diagram of the first action only.

MINER'S HOMESTEAD LEASE (CONT.)

(e) Amalgamation of Homesteads

There are two common methods of amalgamating Homestead Leases:—

- (i) By conditional surrender of all but one of the Homestead Leases and addition of the surrendered areas to the remaining lease.
For the purposes of the plan the amalgamation is then treated as a single addition to the remaining Homestead Lease (See (c) above).
Only the cancelled boundaries of the unsurrendered lease are shown.
- (ii) By conditional surrender of all the Homestead Leases, followed by an application for one new M.H.P.L. covering the whole area. Treat as a new M.H.P.L. Cancelled boundaries are not shown.

(f) Subdivision of a Homestead Lease

- (i) The original Homestead is cancelled, and its description is not shown on the face of the plan.
Each subdivisional block is described by a Lot number
Lot numbers should commence from 1 on each plan, even if more than one Homestead is involved. On large subdivisions which require more than one sheet, the Lot numbers should commence from 1 on the first sheet and be continuous through the remainder.

A tenure table must be shown on all plans of Homestead subdivision.

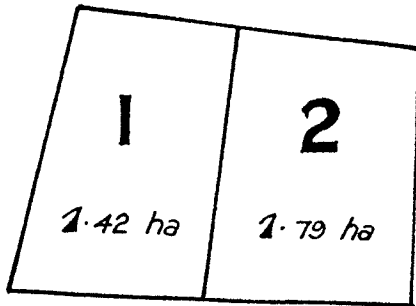

TENURE	
Lot	MHPL
1	
2	

Title..... **LOTS 1&2 CANCELLING MHPL 1372
ON MP 30176**

New leases issued following a subdivision are the same type as the lease being subdivided. Prepare tenure table accordingly.

- (ii) Where more than one Homestead is being subdivided on the one plan and any one Lot is not wholly contained within one Homestead, and exchange must first be effected (see (d) above).
- (iii) There is no longer any provision allowing for part of a subdivided Homestead to remain as an undescribed balance. Any balance area must be completely dimensioned. It may be compiled from original dimensions if necessary.
- (iv) Subdivisions involving more than one Homestead, which would involve complicated exchanges, may be simplified by effecting an amalgamation prior to subdivision, thus dispensing with the need for numerous additions and excisions.
- (v) Where an amending action and subsequent subdivision are shown on the one plan form, the cancelling clause in the title should make no reference to a MP..... as the subject plan is also the plan of the Homestead being subdivided.
- (vi) See SPECIMEN

MINER'S HOMESTEAD LEASE (CONT.)

(g) Areas to be Surrendered for Roads etc.

(i) Areas to be surrendered from Homestead Leases (M.H.L.'s & M.H.P.L.'s) for road or other purposes are to be shown on plans (stating the purpose) as follows:—

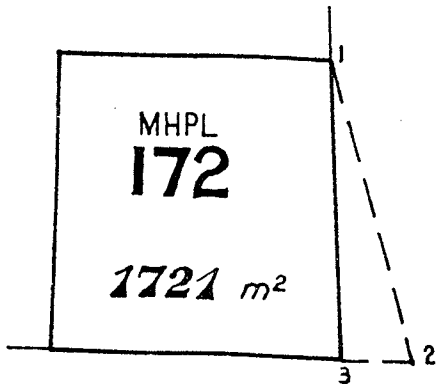

AREA TO BE SURRENDERED FOR ROAD PURPS.
FROM MHPL 172

(1-2-3)..... 215 m²

Title **MHPL 172**

- (ii) When the surrender is not the prime action (e.g. in conjunction with a subdivision) it is not required to refer to the surrender in the title. The surrendered area is endorsed on the face of the plan as above
- (iii) See "UNDESCRIBED BALANCE".

(h) Roads to be closed & Added to

(i) Road closure and addition to an existing Homestead Lease may take place as one action. Show as follows:—

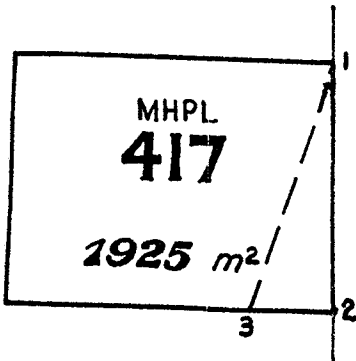

AREA OF ROAD TO BE CLOSED
AND ADDED TO MHPL 417

(1-2-3)..... 176 m²

Title **MHPL 417**

- (ii) When the above action is immediately followed by a subdivision of the enlarged Homestead, both actions may take place on the one plan form (in simple cases) but separate diagrams and complete dimensions must be shown for each action. The area of road to be closed must be endorsed on the plan as above. Cancelled boundaries are shown on the diagram of the first action only
- (iii) Road closure and inclusion in a new Homestead Lease may be shown on the one plan. It is not necessary to refer to the road closure in the plan title, but the area of road to be closed must be endorsed on the plan. Show as follows:—

MINER'S HOMESTEAD LEASE (CONT.)

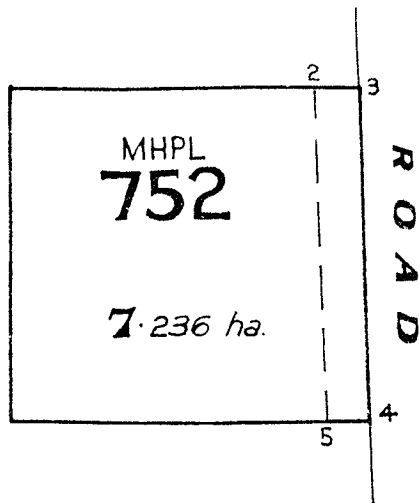

AREA OF ROAD TO BE CLOSED

(2-3-4-5)..... 9045 m²

Title..... **MHPL 752**

(i) **Resumptions**

Treat a similar manner to "Surrenders".

(j) See "ROADS IN HOMESTEADS"

MINES DEPARTMENT CO-ORDINATION AREAS

Additional requirements for plans of all surveys in designated "Mines Department Co-ordination Areas" will be made available from the Senior Staff Surveyor on request.

(a) New M.L.

- (i) A plan of a new Mining Lease must show the external boundaries of the lease, the area held under Surface Rights, any background tenures, and the access to the lease when applicable.

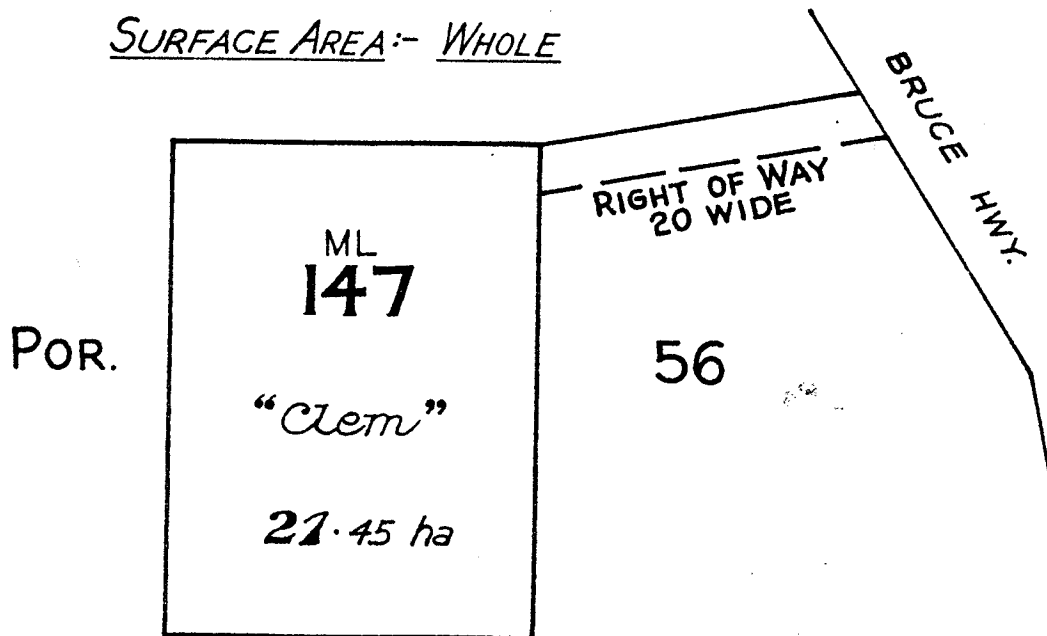

Title..... ML 147 AND RIGHT OF WAY

- (ii) For details regarding Surface Area, see (b) below.
- (iii) For details regarding Background Tenures, see "OTHER TENURES"
- (iv) For details regarding Access, see "RIGHT OF ACCESS" and "RIGHT OF WAY"

(b) Surface Areas

- (i) The Surface Area (whether whole, part, or nil) is shown on the plan by statement,

SURFACE AREA :- WHOLE

or SURFACE AREA :- 25.75 ha.

or SURFACE AREA :- NIL

- (ii) When more than one Surface Area is contained within the one lease, describe as Surface Area No. 1 etc. A calculated area is shown on each and the area of the total surface by statement as shown above.

MINING LEASE (CONT.)

(iii) Show on plan as follows:—

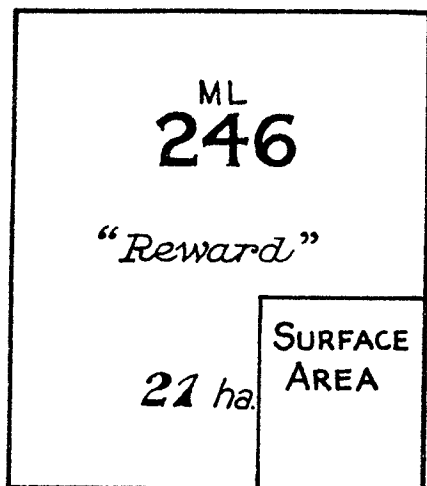
SURFACE AREA :- 4.712 haTitle..... **ML 246**

(iv) Surface Area is referred to in title when the plan is of the Surface Area only

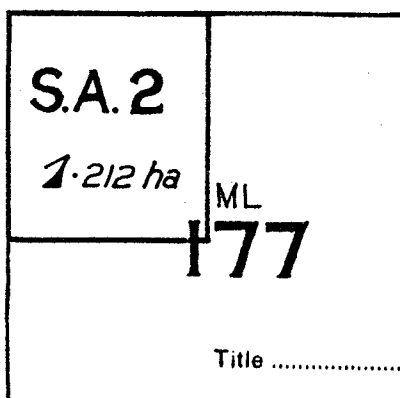
Title **SURFACE AREA No. 2 OF ML 177**(c) **Application Posts**

Show connections to Application Posts either on the face of the plan or tabulate.

(d) **Datum Post**

- (i) All plans of Mining Leases, surveyed or compiled, must describe the position of the applicant's Datum Post, either on the face of the plan or tabulate.
- (ii) See "COMPILED PLANS (e)"

(e) **Depth Restrictions**

- (i) On plans of Mining Leases which are restricted in depth the plan should be endorsed with a suitable statement.

C.M.L. 697 exists only below the depth of 15.24 m beneath the surface, except for Por. 83 where it exists on and beneath the surface.

(f) **Name of Lease**

The name of the Mining Lease is shown within the subject block as illustrated by diagrams in (a) and (b) above.

(g) **Additions to Mining Leases**

Where permissible treat in a similar manner to "Surrenders from Mining Leases" (see (h) below).

(h) **Surrenders from Mining Leases**

- (i) The plan is drawn as if the action were completed (original dimensions and cancelled boundaries if required).
- (ii) Each severance area being surrendered from the lease and surface area, as well as the total area being surrendered is to be shown on the plan.

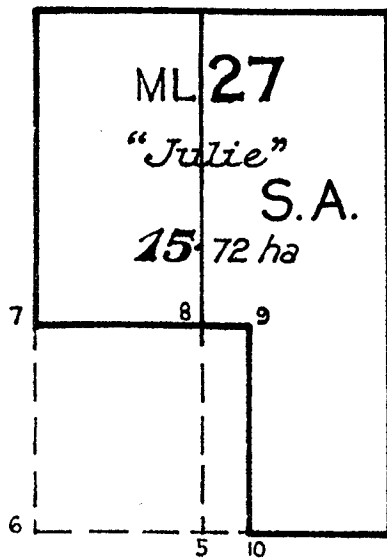

AREA TO BE SURRENDERED FROM
SURFACE AREA OF ML 27

(5-8-9-10).....1.674 ha

AREA TO BE SURRENDERED FROM
ML 27

(6-7-9-10).....5.023 ha

SURFACE AREA:- 10.72 ha

Title **ML 27**

MINING LEASE (CONT.)**(i) Resumptions from Surface Areas of Mining Leases**

Treat in a similar manner to surrenders—stating purpose.

On face *AREA TO BE RESUMED FROM SURFACE AREA OF ML 27
FOR RAILWAY PURPOSES*

Title *SURFACE AREA OF ML 27*

(j) Mining Lease encroaching on M.H.P.L.

The severance areas of any prior M.H.P.L. (but not M.H.L.) covered by the M.L. are to be stated on the plan, for rent reduction purposes, and shown as follows:—

AREA OF ML 1357 WITHIN MHPL 1234

(9-10-11-12)..... 257 m²

(k) See "ROADS IN M.L.'s"

NEW ROAD

- (a) Referred to by Dept. as Road to be Opened
- (b) Roads to be Opened should be drawn on Mines Dept. plan forms only when in a Mining Field.
- (c) In Crown Land simply show as ROAD.
- (d) In existing Homestead Leases see "MINER'S HOMESTEAD LEASE (g)".

OFFICE COMPILATION See "COMPILED PLANS"

OTHER TENURES

Where a Mining Tenement covers lands held under other tenures, all boundaries and the descriptions of those lands are to be shown on the plan. The boundaries of the subject block are to be distinguished by heavier lines. Show underlying descriptions in light block as follows:—

POR 74 MHPL 251

PETROLEUM PERMITS, LEASES, AND LICENCES

- (a) Where for the purposes of the Petroleum Act 1923–1967, or the Petroleum (Submerged Lands) Act 1967–1975, it is necessary to determine the position on the surface of the earth of a point, line or area, that position shall be determined by reference to the Australian Geodetic Datum; and any plan depicting such position should be endorsed:—

Australian Geodetic Datum

- (b) Where bearings are given, both forward and reverse azimuths must be shown where applicable.

PETROLEUM WELL LOCATION SURVEYS

Plan requirements for Well Location Surveys as required under Reg. 117 of the Petroleum Regulations (Land) 1966 will be made available upon request, from the Senior Staff Surveyor.

PLAN FORMS

- (a) Except under special circumstances approved by the Senior Staff Surveyor, surveys of all Mining Tenements are to be drawn on Mines Department plan forms.
- (b) New Surveys of two or more tenements may not be drawn on the plan form unless each parcel is physically connected to the other by survey.
- (c) Plan forms are available in 2 sizes and are obtainable from the Senior Staff Surveyor.

PORTIONS

- (a) A Mines Department Portion is defined by placing the letter "M" after the portion number.
- (b) A Tenure Table must be shown on all plans of Mines Department Portions
- (c) See "MINER'S HOMESTEAD LEASE (b)"

RE-MARK SURVEYS See "IDENTIFICATION SURVEY"

RESTRICTED MINING PURPOSES CLAIM (R.M.P.C.)

Plan requirements for surveys of R.M.P.C.'s as directed under Reg. 29 (A)S are the same as for Mining Leases.

RESUMPTIONS See "MINER'S HOMESTEAD LEASE (i)" and "MINING LEASE (i)"

RIGHT OF ACCESS

- (a) A Right of Access is over Crown Land for a Mining Tenement on Crown Land.
- (b) Normally surveyed only when instructed by the Warden or Under Secretary.
- (c) Treat generally as for an Easement. Show width of Right of Access and secants.
No area is required.
- (d) If only one side is run show the surveyed boundary by a full line and the opposite side in a broken line.
- (e) Show on plan as follows:—
 - (i) On face

**RIGHT OF ACCESS
20 WIDE**

(ii) Title (as the case dictates)

M.L. 53 AND RIGHT OF ACCESS
 or *M.L.'s. 52 AND 53 AND RIGHT OF ACCESS (M.L.53)*
 or *RIGHT OF ACCESS (M.L.53)*

(f) See "RIGHT OF WAY"

RIGHT OF WAY

- (a) A Right of Way shows access to a Mining Tenement on Private Land.
- (b) Treat generally as for a Mining Lease. Show width of Right of Way and secants.
No area is required.
- (c) If only one side has been run (allowable only when Right of Way passes through Crown Land) show the surveyed boundary in a full line and the opposite side in a broken line.
- (d) Show on plan as follows:—
 - (i) On Face

**RIGHT OF WAY
10 WIDE**

RIGHT OF WAY (CONT.)

(ii) Title (as the case dictates)

M.L. 71 AND RIGHT OF WAY
 or *M.L's. 70 AND 72 AND RIGHT OF WAY (M.L. 72)*
 or *RIGHT OF WAY (M.L. 71)*

(e) See "RIGHT OF ACCESS"

ROADS IN HOMESTEADS

When a section of surveyed road (railway, channel area, reserve etc.) severs a Homestead Lease the severances of the Homestead are to be joined by a binder and a 3 line area is to be shown. The road boundaries should be fully dimensioned. If only one side is surveyed the unsurveyed side is to be shown as calculated.

MHPL

ROAD 20 WIDE

7170

1.732 ha
2869 m² Rd.
1.445 ha

ROADS IN MINING LEASES

- (a) There are four methods of showing areas of dedicated roads through M.L.'s on a plan, depending upon the form of the M.L. Application.
- (i) The road may be included in the M.L. if an application to disturb the road surface is approved by the Governor in Council (The most common case).

120.5 ha
2.746 ha Rd.

The road boundaries are shown in light lines.

- (ii) The road may be excluded from the M.L. in the terms of the lease.

120.5 ha
2.746 ha Rd.
117.8 ha

The road boundaries are shown in heavy lines.

Join the severances with a binder.

ROADS IN MINING LEASES (CONT.)

- (iii) The road may be excluded only from the Surface Area of the M.L. in the terms of the lease.

120.5 ha
2.746 ha Rd.

The road boundaries are shown in medium lines.
The surface area is shown by statement.

- (iv) Where no surface area is required for the M.L. the area of the road is not shown, only the area of the M.L.

120.5 ha

The road boundaries are shown in light lines.

- (b) In all cases the surveyed road boundaries should be plotted on the plan. Full dimensions of the road are required in cases (i) to (iii) above.

SPECIAL COAL MINING LEASE (S.C.M.L.)

Plan requirements for S.C.M.L.'s are the same as for Mining Leases.

SPECIAL GEM CLAIM (S.G.C.)

Plan requirements for S.G.C.'s as directed under Reg. 29Y are the same as for Mining Leases.

SPECIAL MINING LEASE (S.M.L.)

Plan requirements for S.M.L.'s are the same as for Mining Leases.

SPECIAL PERPETUAL MINING PURPOSES LEASE (S.P.M.P.L.)

Plan requirements for S.P.M.P.L.'s are the same as for Miner's Homestead Perpetual Leases.

SPECIFIC AREAS

Specific Areas, such as Residence Areas (R.A.'s), Business Areas (B.A. s) etc. see "CLAIMS AND AREAS".

STATUTORY MINE WORKING PLANS

- (a) Drawing requirements for Statutory Mine Working Plans will be made available from the Senior Staff Surveyor on request.
(b) Plans must be drawn on official Mines Department Statutory Mine Working Plan sheets, obtainable from the Senior Staff Surveyor.

SUBDIVISION OF M.H.L.'s and M.H.P.L.'s See "MINER'S HOMESTEAD LEASE (f)"**SUBLEASE**

Plan requirements for Subleases are the same as for Miner's Homestead Perpetual Leases.

SURFACE AREAS See "MINING LEASE (b)"**SURRENDERS** See "MINER'S HOMESTEAD LEASE (c) & (g)" and "MINING LEASE (h)"**TENURE TABLE**

- (a) A Tenure Table must be shown on all plans of Mines Department Portions, Town Sections and Subdivision of a Homestead.
(b) See "MINER'S HOMESTEAD LEASE (b)", "PORTIONS" and "TOWN SECTION"

TITLE

(a) Show on plan as follows:—

(i) PLAN OF *MHPL 1275*
For further details refer to respective tenure.(ii) PARISH *GYMPIE*(iii) COUNTY *March*(iv) MINING DISTRICT *Mareeba*(v) LOCALITY *Quamby*(vi) MINING FIELD *Anakie*

(b) See "STYLES" (Detailed Drafting Standards) and SPECIMEN PLANS

TOWN SECTION

- (a) A "Tenure Table" must be shown on all plans of Allotments of Sections
- (b) Where an adjoining allotment is occupied by a Homestead Lease, show the allotment number only.
- (c) See "MINER'S HOMESTEAD LEASE (b)"

UNDERLYING DESCRIPTIONS See "OTHER TENURES"**UNDESCRIBED BALANCE**

In the case of an excision from a Homestead Lease or Mining Lease the balance of the Lease should be shown on the plan where possible. The Lease may be left as an undescribed balance and omitted from the plan only with the prior approval of the Senior Staff Surveyor. An undescribed balance is not permissible in the case of a subdivision of a Homestead.

WELL LOCATION SURVEYS See "PETROLEUM WELL LOCATION SURVEYS"

REQUIREMENTS
OF THE
REGISTRAR
OF TITLES

alance

Where possible plans lodged with the Registrar of Titles should be drawn with the surveyed information (Reference Marks etc.) shown on the face of the plan - See T.O. Specimen Plan.

ALTERATIONS & ADDITIONS

Before a plan is "registered" any amendments will entail return of plan to the Surveyor who will then "Add or Alter" information in RED. Plan will also be endorsed and signed in Red by the Licensed Surveyor.

Eg. Amendments in red by me on 20th July, 1978.

.....
Licensed Surveyor.

AREAS

1. See Page 9 of this manual.
2. Conversions Imperial to Metric.
Imperial areas are converted to the same accuracy as that of the new parcel being excluded.
3. All balance areas are the same accuracy as the parcel being excluded.

BEARINGS

As shown in Field Notes or Survey Record.

BUILDING UNITS & STRATA TITLES

For plan requirements see the "Buildings Units Titles Act of 1965."
(Note: A combined Act is in the process of being formulated)

COMPILATIONS (PLANS WITHOUT FIELD SURVEY)

When the requirements of the Registrar have been known and satisfied, plans without field survey can be lodged by the Licensed Surveyor. Plans are to be endorsed and signed as per Form 13, Part B, Surveyors Regulations 1978. A statement as to the source of the information utilised in the compilation of the plan must also be incorporated in the certificate.

Eg.and that the plan is accurate, and compiled from RP.1234 in the Titles Office, Townsville.

and/or from S1.1234 in the Office of the Surveyor-General.
and/or from M.P. 1234 in the Mines Department, Brisbane.

EASEMENTS & LEASES

All subject Easements - Leases and other Registered encumbrances are to be plotted on the subject Block together with the plan number (or document reference if no plan exists). This is also done for any adjacent Emts. etc. that may abut directly on to a subject boundary.

GROUP TITLES

For Plan requirements see "The Group Titles Act of 1973."

IDENTIFICATION SURVEYS - REMARKINGS ETC

A copy of the plan is lodged endorsed and signed by the Licensed Surveyor as follows.

eg. I hereby certify that I have identified and remarked the boundaries as shown hereon.

.....
Licensed Surveyor.
20.7.78

See also Regulation 31 of the Surveyors Regulations 1978.

LOTS

Lots should normally be numbered from unity on every plan lodged, although in some actions it may be advantageous to retain existing number or numbers. It is also appreciated that some large survey projects cannot all be contained on one plan, and that the sequence in which the plans will be lodged is unpredictable. In such cases where the Surveyor will be committed to Lot Numbers allocated in early stages of design, it is desirable that a Lot Number does not exceed three digits.

MERIDIAN

Plans are usually drawn direct from the Field Notes or Survey Record on the Meridian of the previous plan. Details of Astronomical Observations can be shown if Survey Records are not lodged. When Survey Records are lodged a statement can be shown on the plan as follows.

eg. For details of Sun Observation for reduction to County Arbitrary Meridian - see Field Notes.

See also Regulation 33 of The Surveyors Regulations 1978

RESTRICTED TITLES (TITLES TO THE DEPTH & BELOW THE DEPTH OF)

These must be clearly shown in capitals, underlined and placed towards the bottom of the plan form if possible.

eg. TO THE DEPTH OF 15.235 METRES FROM THE SURFACE ONLY

RESURVEYS

See Identification Surveys.

STRATA TITLES

See Building Units.

d

d,
ing
ey
ence
ses
n
not

SPECIMEN PLANS

OF)

TRAVERSES ETC

LINE	BEARING	DIST.	
1	54°25'	31.09	
2	130°33'	89.59	
3	338°17'	119.11	
4	130°33'	193.96	
5	66°09'	33.46	
6	181°45'	42.72	
7	"	5.22	
8	"	107.77	
9	14	254°56'	40.47
10	15	"	37.82
11	13	269°59'	68.51
12	17	181°45'	103.08
13	19	91°45'	38.54
14	20	167°30'	31.14
15	24	181°45'	30.18
16	27	179°37'	30.2
17	29	"	57.06
18	30	169°21'	30.9
19	31	271°45'	23.78
20	33	"	38.29
21	41	"	30.8
22	36	181°45'	160.93
23	38	84°29'	50.2
24	37	91°45'	50.04
25	39	179°37'	30.2
26	40	mmt only	21.09

Area of New Road

MHL 1106 (5-3-13)	4102	m ²
Por. 317 (13-3-8)	4797	m ²
Allot 1 (26-27-28)	2912	m ²
Allot 2 (28-40-29)	2501	m ²
Allot 3 (29-40-20)	2090	m ²
Lot 1 (31-30-36)	6446	m ²
R3 (33-31-36)	1843	m ²
Resub. 1 (2-1-4)	2483	m ²
(19-17-18)	1986	m ²
Total	4469	m²

Area excised from Emt A
(7-15-6) 196 m²

Gen RFP (AR) at stns 12, 13, 15, 18 & 19

Graded Peg. pid at stns 10, 20, 26, 28-30, 33-38

Survey Post pid at stn 3

M.H.L. 1106
13421

Resub. 1
Er 3517

Sub. 1

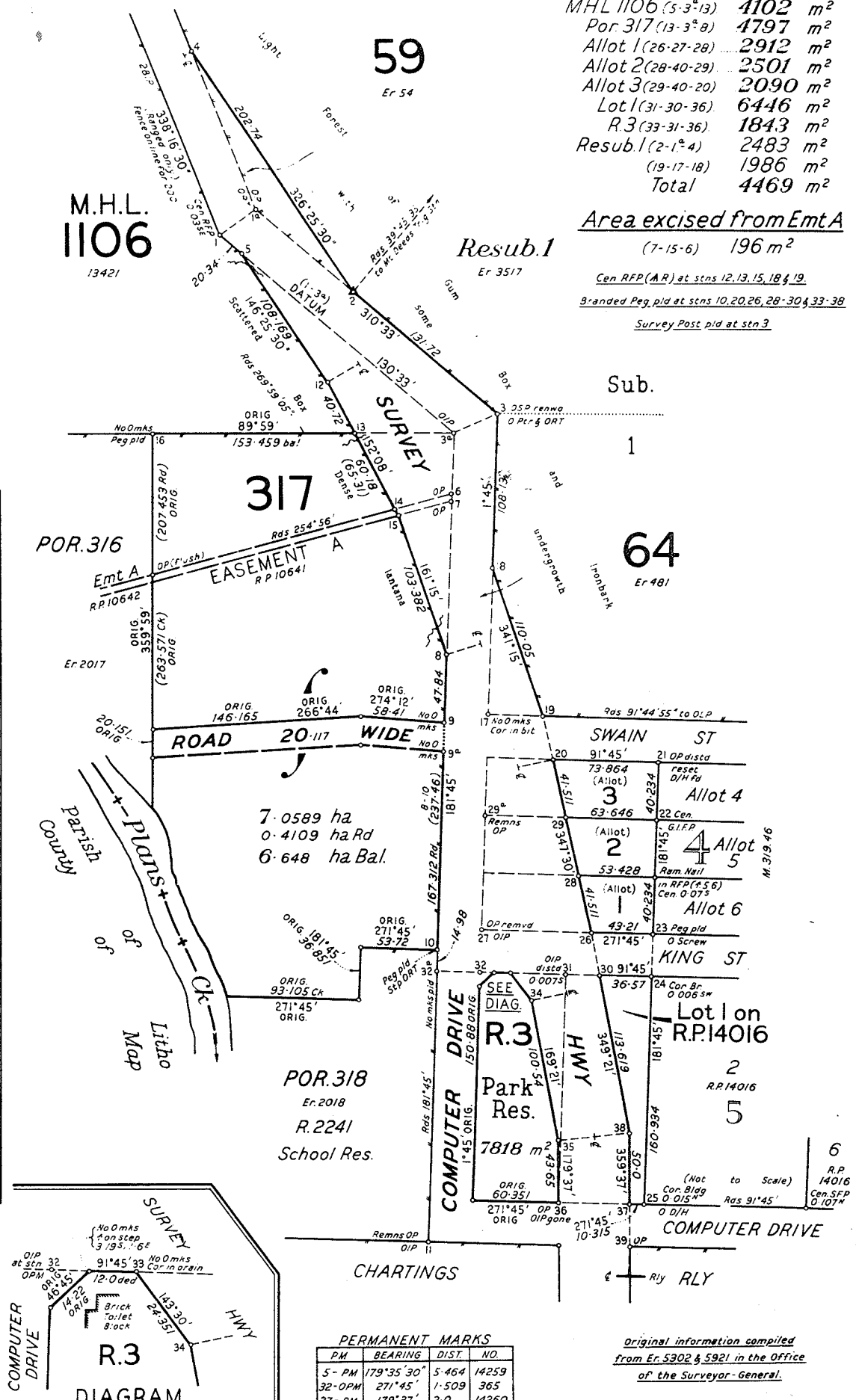

REFERENCE MARKS

TO	BEARING	DIST.	BRAND
O Blwd	45°25'	13.61	burnt
Pin	326°25'30"	1.005	
Ironbk	95°17'	8.19	A.R.
O.Ptr	310°33'	4.023	
O.Box	179°44'	20.22	A 59 64
O.P.	269°59'	1.006	
Pin	146°25'30"	1.0	
Box	12°56'	14.92	A.R.
Pin	181°45'	1.0	
Stp. O.R.T.	289°31'	22.01	
O.P.	1°45'	1.006	
Pin	152°08'	1.0	
Mahog.	244°35'	18.99	A 1106 R
Pin	269°59'	1.0	
"	332°08'	"	
Pin	332°08'	1.0	
Pin	1°45'	1.0	
Gum.	160°40'	10.22	A.R.
Pin	91°45'	1.0	
D.Hole in Ardr.	34°25'	1.579	
O.Screw in conc.	181°45'	2.012	
O.D.Hole in rail	0.1014"	0.3194	
Pin	167°30'	1.0	
O.P.Flush	91°45'	1.006	
Pin	169°21'	1.0	
Pin	359°37'	1.0	
P.Pole No. 541	150°22'10"	15.269	A
Pin	179°37'	1.0	
Gen RFP	0.35	0.024	

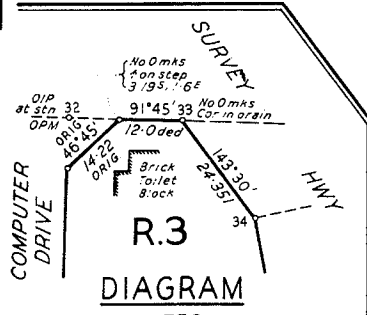

PERMANENT MARKS

PM	BEARING	DIST.	NO.
5-PM	179°35'30"	5.464	14259
32-OPM	271°45'	1.509	365
37-PM	179°37'	2.0	14260

Original information compiled from Er. 5302 & 5321 in the Office of the Surveyor-General.

R.3, Por. 317 and Road in Allots 1-3 of Sec. 4, Lot 1 on R.P. 14016 (Orig. Allot 2 of Sec. 5) TOWN OF MAP & in M.H.L. 1106 & Resub. 1 of Sub. 1 of Pors. 59 & 64.
PARISH OF METRIC
County of **Eraser**
L.A. District of **Pencil**

INSTRUCTIONS	DRAWN	CHECKED	REGISTERED	CHARTED		
77K1/121	G.S.					
21-12-77	1-5-78					
ADJUSTMENTS						
POR.	PREV. AREA	DRAWN	EXAMINED	CHECKED	PASSED	CHARTED
2	4° 13' 51"	4° 14' 2"				
C. A. M.						

SURVEY PLAN

SCALE 1:2000

SURVEYED BY	DATE	FIELD NOTES
G.T. Box	14-1-78	77K1/121 5-2-78

CROWN COPYRIGHT RESERVED

SPECIMEN

REFERENCE MARKS

STN	TO	BEARING	DIST.	BRAND
1	Cent RFP	185°27'	1.57	
4	Nail in herb	90°01'	1.0	
5	OIP	180°01'	1.006	0.4 deep
6	Pin	0°01'	1.0	
7	Cor. brick	0.04 ^s 0.09 ^w		
9	OIP	180°01'	1.0	
	C.Face SFP	0.96 ^m 0.71 ^m		

TRAVERSES

LINE	BEARING	DIST.
1-1 ^a	180°01'	4.0
1-1 ^b	270°01'	4.0

PERMANENT MARKS

PM	BEARING	DIST.	NUMBER
2-PM	90°01'	1.0	1357

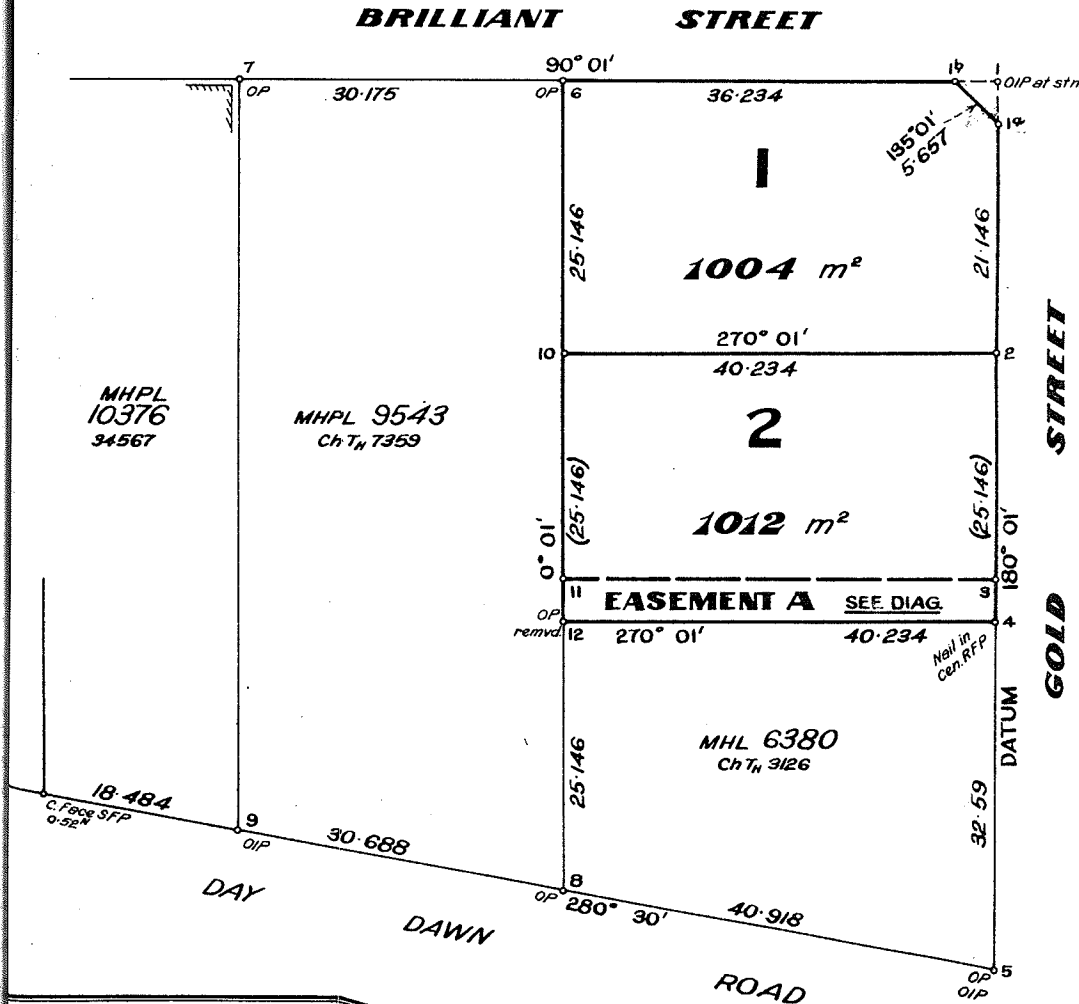

TENURE	
LOT	NEW MHPL
1	
2	

DIAGRAM NOT TO SCALE

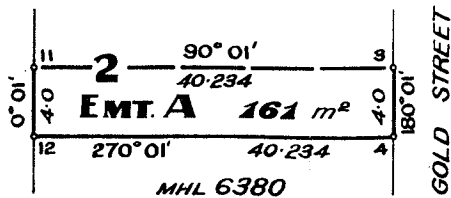

Star Picket in conc. at stn. 12
AREA TO BE SURRENDERED FOR ROAD PURPS.
FROM MHPL 9876 (1^b-1-1^a-1^b)..... 8 m²
Branded plastic peg placed at stns.
1^a, 1^b, 2, 3, 10, 11.

FIELD NOTES LODGED					LINES NOT SURVEYED		STNS		CORNERS NOT MARKED		STNS		
R No.	RECEIVED	DRAWN	CHARTED	DUP-WARD	PLAN OF LOTS 1 AND 2 AND EMT. A IN LOT 2 CANCELLING MHPL 9876 ON MP Ch.T. 1234								
Rate		JK			PARISH CHARTERS TOWERS COUNTY Davenport MINING DISTRICT Charters Towers								
MINED	CHECKED	LOCALITY			MINING FIELD			MAP REF					
		Day Dawn			Charters Towers			PROC. SURVEY AREA					
					SURVEYED BY					MERIDIAN		SCALE	
					Lincoln A Myall					ON MERIDIAN OF Ch.T. 1234		1:500	
					1.1.5.78							Cat. No. SPECIMEN	

Plan must be drawn within blue lines

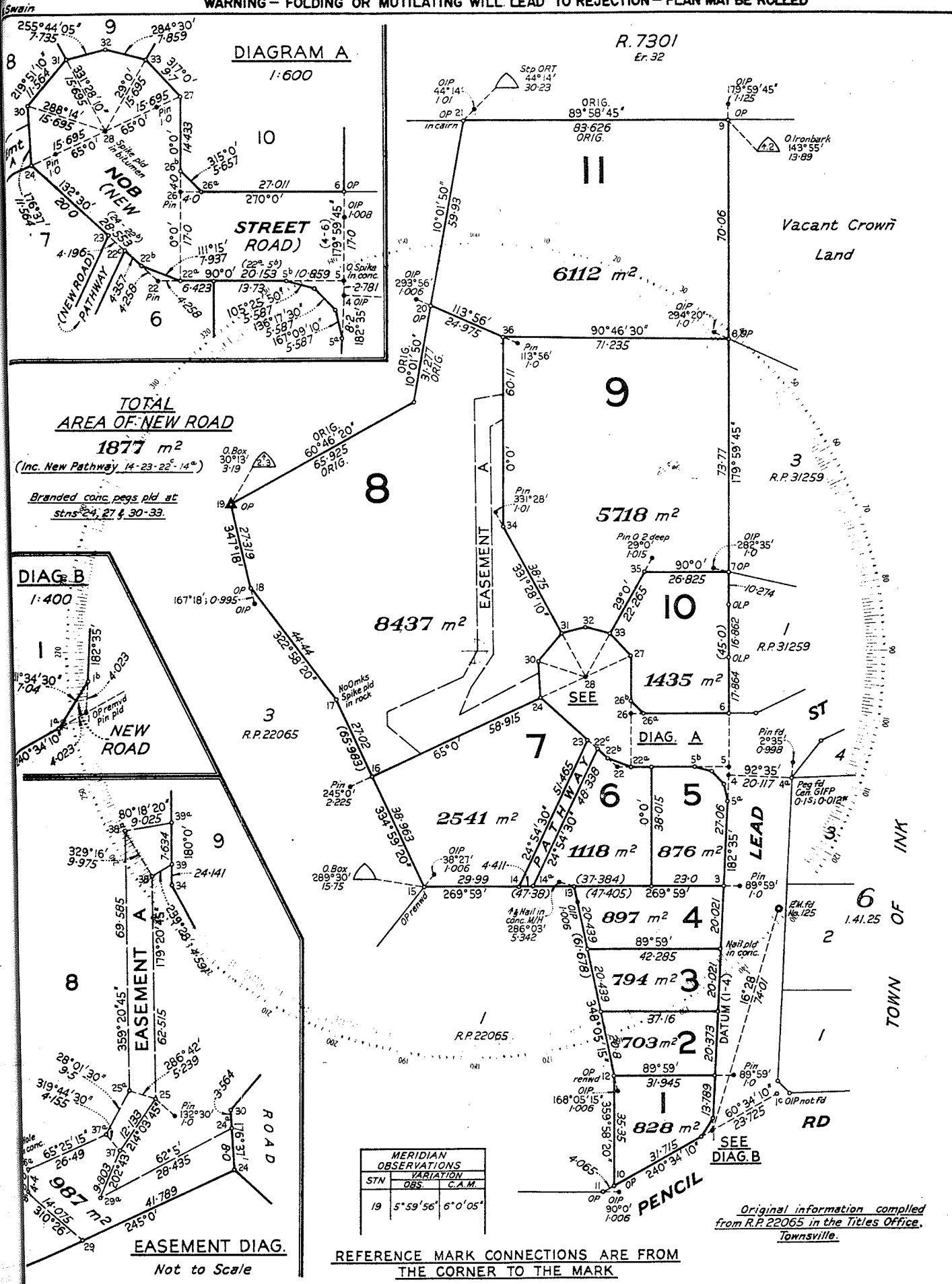

PLAN MUST BE DRAWN WITHIN BLUE LINES

FIELD NOTES LOGGED	LINES NOT SURVEYED	STNS	CORNERS NOT MARKED	STNS
PLAN PORTION	292		PLAN OF Lots 1 - 11 & Easement A in Lot 8	
PLAN GRANT	Cancelling Lot 2 on R.P.22065		TOWN	METRIC
REF.	PROCLAIMED SURVEY AREA	SURVEYED BY L. Surveyor 16.1.5.1978.	MERIDIAN	SCALE 1:1000
				PLAN SPECIMEN

CERTIFICATE

I, Alan William Best Richitage
hereby certify that *I have* surveyed the land comprised in this plan
personally

that the plan is accurate, that the said survey was performed in accordance with the
"Surveyors Act 1977" and the "Surveyors Regulations 1978" and that the said
survey was completed on *6.7.1978*

.....
A.R. (Signed)

Signature of Licensed Surveyor

Date *12.7.1978*

CERTIFICATE

I, Alan William Best Richitage
hereby certify that *I have* surveyed the land comprised in this plan
by John William Jackson, Licensed Surveyor for whose work I
accept responsibility

that the plan is accurate, that the said survey was performed in accordance with the
"Surveyors Act 1977" and the "Surveyors Regulations 1978" and that the said
survey was completed on *6.7.1978*

.....
A.R. (Signed)

Signature of Licensed Surveyor

Date *12.7.1978*

CERTIFICATE

A.W.B. Richitage (Surveys) Pty. Ltd
hereby certify that *the company has* surveyed the land comprised in this plan
by John William Jackson, Licensed Surveyor for whose work
the company accepts responsibility

that the plan is accurate, that the said survey was performed in accordance with the
"Surveyors Act 1977" and the "Surveyors Regulations 1978" and that the said
survey was completed on *6.7.1978*

.....
M.R. (Signed)

Director

.....
A.R. (Signed)

Director

Signature of Licensed Surveyor

Date *12.7.1978*

