

Land tenure records

LOCAL SKETCH
Scale - 4 Miles to an Inch

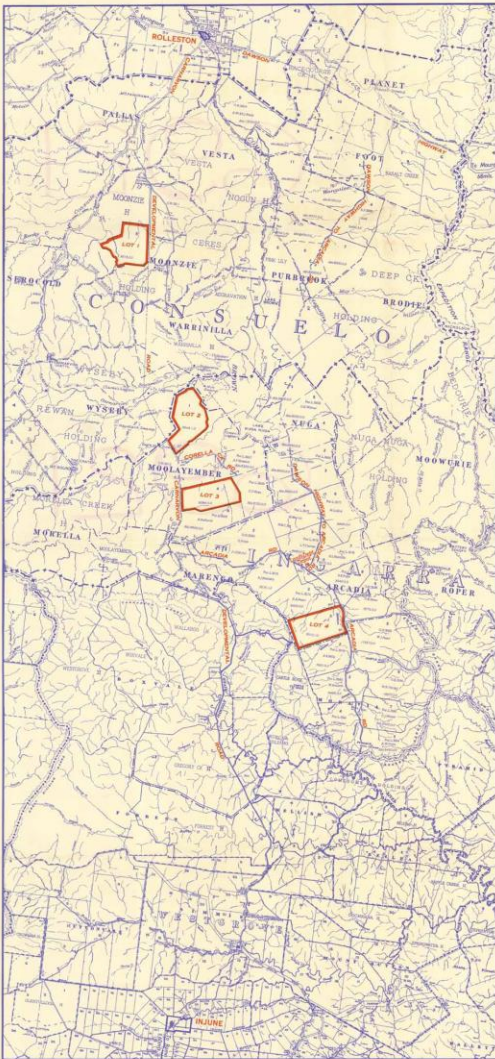

DRAWN BY THE SURVEY OFFICE, AND PUBLISHED BY THE DEPARTMENT OF LANDS,
PRINTED BY THE GOVERNMENT PRINTER'S OFFICE,
BRISBANE, JANUARY, 1965.

BRIGALOW LAND WITH FREEHOLDING TENURE FOR PUBLIC AUCTION

LAND DEVELOPMENT (FITZROY BASIN) SCHEME — SPRINGSURE LAND AGENT'S DISTRICT
ON BEHALF OF THE QUEENSLAND GOVERNMENT

ELDER SMITH GOLDSBROUGH MORT LIMITED and DALGETY AND NEW ZEALAND LOAN LIMITED
AS AUCTIONEERS IN CONJUNCTION

WILL OFFER FOR SALE AT AUCTION FOUR(4) LOTS OF LAND AS DESCRIBED BELOW UNDER FREEHOLDING TENURE

AT THE MEMORIAL HALL, INJUNE ON WEDNESDAY, 17th MARCH, 1965, AT 12 noon

TERMS—FULL AMOUNT OF SURVEY FEE AND 1/10th of PURCHASING PRICE PAYABLE IMMEDIATELY AT TIME OF SALE; BALANCE OF PURCHASE MONEY PAYABLE IN TEN EQUAL ANNUAL INSTALMENTS TO INCLUDE PRINCIPAL AND INTEREST AT 5%.
DECLARED VALUE OF IMPROVEMENTS (WHICH IS ADDITIONAL TO SURVEY FEE AND PURCHASING PRICE) PAYABLE WITHIN ONE MONTH FROM DATE OF SALE, EXCEPTING THE DECLARED VALUE ON LOT 1 WHICH UNDER CERTAIN CONDITIONS MAY BE PAID OVER 5 YEARS (SEE DETAILS UNDER HEADING "IMPROVEMENTS" HEREUNDER)



FURTHER ENQUIRIES, INFORMATION, ETC.
The Selling Agents have offices in the area of Injune and Home (Near South Goldborough Main Line) and Springsure and Home (Dalgety and New Zealand Loan Limited).
For further particulars or means of inspection contact the Brisbane office or any branch of the two agents mentioned or any office of the Queensland Lands Department or the Lands Department Offices at Carina Creek on the Dawson Highway or in the Aracata Valley.

60/10-1-65 Page 4445A-1
Being 3/10 of Section
Over to A.B.F. 7-3-65
60/10-1-65 Page 4445A-2
Being 1/10 of Section
Over to A.B.F. 7-3-65
60/10-1-65 Page 4445A-3
Being 2/10 of Section
Over to A.B.F. 7-3-65
60/10-1-65 Page 4445A-4
Being 3/10 of Section
Over to A.B.F. 7-3-65

THE LAND DEVELOPMENT (FITZROY BASIN) SCHEME
This scheme was established under the provisions of the Land Development (Fitzroy Basin) Act, 1964, and the land under this scheme is being developed for agricultural purposes. The scheme is divided into four lots, each of which is being offered for sale at public auction. The land is situated in the Springsure Land Agent's District and is bounded by the Queensland State Road on the north and the Queensland State Road on the south. The land is also bounded by the Queensland State Road on the east and the Queensland State Road on the west.

3RD SALE

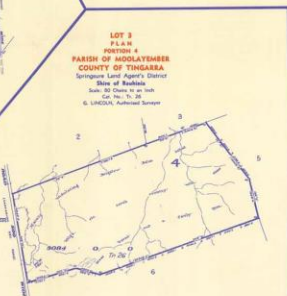

LOT 1
2.1 A.C.
PARISH OF MOONZIE
COUNTY OF CONDOLFO
Springsure Land Agent's District
Site of Sale
See 2/10 of Section
Over to A.B.F. 7-3-65
J. K. CAMPBELL, Auctioneer

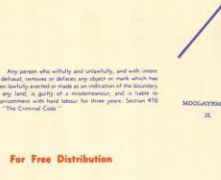

Lot No.	Area (Acres)	Area (Hectares)	Area (Sect.)	Area (Sect.)	Area (Sect.)	Area (Sect.)
1	100.00	4046.86	100.00	100.00	100.00	100.00
2	100.00	4046.86	100.00	100.00	100.00	100.00
3	100.00	4046.86	100.00	100.00	100.00	100.00
4	100.00	4046.86	100.00	100.00	100.00	100.00

AMENITIES AND SERVICES
The land is situated in the Springsure Land Agent's District and is bounded by the Queensland State Road on the north and the Queensland State Road on the south. The land is also bounded by the Queensland State Road on the east and the Queensland State Road on the west.

IMPROVEMENTS
The value of improvements on the land is to be determined by the Queensland Lands Department. The value of improvements on the land is to be determined by the Queensland Lands Department.

FINANCIAL PRICE, SURVEY FEE, DECLARED VALUE OF IMPROVEMENTS
The value of improvements on the land is to be determined by the Queensland Lands Department. The value of improvements on the land is to be determined by the Queensland Lands Department.

SECTION 171 OF THE LAND ACTS 1962-1964
The value of improvements on the land is to be determined by the Queensland Lands Department. The value of improvements on the land is to be determined by the Queensland Lands Department.

For Free Distribution

DR2810 - Map of Brigalow Land with freeholding tenure available for Public Auction, 17 March 1965

Research Guide to land tenure records at Queensland State Archives

Queensland State Archives (QSA) is the official repository for Queensland Government records selected for permanent retention because of their continuing value. The archived public records are from state government departments, state courts, local government authorities and statutory authorities. The records are in our facility at [Runcorn, Brisbane](#), and open records are available for viewing in the Reading Room, free-of-charge.

The main finding aid for records held at QSA is the [Queensland State Archives' online catalogue](#) (known as ArchivesSearch).

The following citation abbreviations are used throughout our catalogue:

ITM	QSA Item (describes the item)
PR	Physical Representation (generally the original or microfilm copy)
DR	Digital Representation (for a digital image)
S	Series ID (for series of records)
A	Agency ID (for the creating or responsible agency).

Aboriginal and Torres Strait Islander readers are advised that our catalogue contains images, names and voices of people who have died.

Information about land tenure is found in the records created by the Surveyor General's Department, the Survey Office, the Office of the Chief Commissioner for Crown Lands, the Department of Lands and Works, the Lands Department, and subsequent names of the agency responsible for land records – the most recent is the Department of Resources.

Files about land tenure are often accessed by searching for the name of the land holder in [ArchivesSearch](#). However, many land records are arranged by form of tenure, and the Land Agent or Crown Lands Commissioner's district. To use these records, it is necessary to determine the form of tenure such as pastoral lease, occupation license, selection, special lease or freehold. Further, the conditions for land tenure changed over time with changes to the relevant legislation.

To conduct historical land research, knowledge of three components of land administration is important. These components are administrative areas, property descriptions and land tenure. More detail is available in [Land 101](#) compiled by Kaye Nardella of the Museum of Lands, Mapping and Surveying.

The main series of land records held at QSA are pastoral leases, occupation licenses, land selections, special leases, freehold title and freehold tenure. These forms of land tenure are generally defined as:

- A *pastoral lease* is a large area of land rented for a fixed period of time from the Crown for pastoral purposes. Pastoral leases are sometimes referred to as runs, stations, blocks or pastoral holdings. The Crown retains the right to resume parts of the leasehold in certain circumstances. Tenancy is usually long term. Types of pastoral leases include preferential pastoral lease, development pastoral lease, prickly pear pastoral lease, stud pastoral lease and forest grazing lease. It was common for farmers to secure improvements on the pastoral property which were usually the homestead and other buildings from being taken over by the Crown at the expiration of the lease, by purchasing the property immediately surrounding the homestead. Therefore, pre-emptive purchases made under section 54 of the *Pastoral Leases Act, 1869* converted part of the lease to freehold title.
- An *occupation license* is a large area of land rented for a maximum of one year from the Crown for pastoral purposes. The license may be renewed annually if the Crown does not require the land. Similar to the pastoral lease with the exception that it is short term and generally for smaller areas of land.

- A *land selection* is a small area of land rented from the Crown for agricultural or grazing purposes. Most types of selections are convertible, that is, they are designed to be converted to freehold tenure after a fixed number of years, provided the selector fulfils certain conditions such as residence by the selector or his bailiff on the land, improvement to a set value, and payment of an annual rent. There are various types of selections such as agricultural farm, grazing farm, grazing homestead, prickly pear or perpetual lease.
- A *special lease* of Crown Land may be granted for a fixed term for manufacturing, industrial, residential, business or recreational purposes.
- A *freehold title* is any piece of land purchased outright. A Deed of Grant is issued upon the first sale of a property. A Certificate of Title is issued upon any subsequent sale and transfer.
- A *freehold tenure* is a lease that converts to freehold if conditions are met, such as repaying money owed.

Some land tenure records prior to the separation from New South Wales in 1859 are also held at Queensland State Archives, most land records for this period are at the State Records Authority of New South Wales.

Pastoral leases

Papers Relating to the Transfer of Run Leases

Circa 1/1/1848–31/12/1874

[S12061](#)

Specific record of interest in this series are:

Papers concerning the transfer of leases in the Moreton Bay Region

Circa 1/1/1848–31/12/1874

[ITM7656](#), [DR24599](#) and [DR24600](#)

Registers of demands made for leases to pastoral runs in the various Pastoral Districts

Circa 1/1/1848–31/12/1870

[S12035](#)

Specific records of interest in this series are:

Register of demands

Circa 1/1/1848– 31/12/1868

[ITM7561](#)

Register of demands

Circa 1/1/1858–31/12/1870

[ITM7562](#)

Run Registers

Circa 1/1/1849–31/12/1979

[S13924](#)

These registers include the name of run, name of lessee, area, description of land, dates of application, action on lease (transfer, forfeiture, surrender of lease), references to consolidations, details of rent.

Specific records of interest in this series include the following registers of runs and register sheets for runs.

Register of runs in Pastoral Districts

Burke under the *Crown Lands Alienation Act 1868*

Circa 1/7/1873–31/7/1873

[ITM23386](#)

Darling Downs under the *Crown Lands Alienation Act 1868*

Circa 1/7/1868– 31/7/1868

[ITM23387, DR59099](#)

Kennedy under the *Crown Lands Alienation Act 1868*

Circa 1/1/1869–31/1/1878

[ITM23388](#)

Moreton under the *Crown Lands Alienation Act 1868*

Circa 1/7/1868–31/7/1878

[ITM23389](#)

Port Curtis under the *Crown Lands Alienation Act 1868*

Circa 1/4/1868–31/7/1878

[ITM23390](#)

Wide Bay and Burnett under the *Crown Lands Alienation Act 1868*

Circa 1/1/1869–31/12/1877

[ITM23391](#)

Darling Downs under *Settled Districts Pastoral Leases Act 1876*

Circa 1/11/1878–31/10/1880

[ITM23420, DR65645](#)

Kennedy under the *Settled Districts Pastoral Leases Act 1876*

Circa 11/9/1877–5/9/1882

[ITM23421, DR65646](#)

Moreton under the *Settled Districts Pastoral Leases Act 1876*

Circa 1/6/1877–30/9/1882

[ITM23422, DR65647](#)

Port Curtis under *the Settled Districts Pastoral Leases Act 1876*

Circa 1/11/1877–30/6/1882

[ITM23423, DR65648](#)

Wide Bay and Burnett under the *Settled Districts Pastoral Leases Act 1876*

Circa 1/4/1879–30/6/1882

[ITM23424, DR65649](#)

Register sheets for runs

Abbey Peak - Ayrshire Downs

Circa 1/1/1904–31/12/1977

[ITM294889](#)

Babbiloora - Blunder Park

Circa 1/1/1904–31/12/1977

[ITM294890](#)

Register of demands

Circa 1/1/1858–31/12/1870

[ITM7562](#)

Boah – Byroya

Circa 1/1/1904–31/12/1977

[ITM294891](#)

Cabbage Tree – Copesland
Circa 1/1/1904–31/12/1977
[ITM294892](#)

Eaglefield - Funnell Junction
Circa 1/1/1904–31/12/1977
[ITM294894](#)

Haddon – Justin
Circa 1/1/1904–31/12/1977
[ITM294896](#)

Labona – Lythe
Circa 1/1/1904–31/12/1977
[ITM294898](#)

Mooraberree – Myuna
Circa 1/1/1904–31/12/1977
[ITM294900](#)

Packsaddle - Quita Creek
Circa 1/1/1904–31/12/1977
[ITM294902](#)

Scardons Hill - Sypher Park
Circa 1/1/1904–31/12/1977
[ITM294904](#)

Truno – Weymouth
Circa 1/1/1904–31/12/1977
[ITM294906](#)

Corea – Dysart
Circa 1/1/1904–31/12/1977
[ITM294893](#)

Gadara – Gylanda
Circa 1/1/1904–31/12/1977
[ITM294895](#)

Kaampa – Kyra
Circa 1/1/1904–31/12/1977
[ITM294897](#)

Maaland – Moonzie
Circa 1/1/1904–31/12/1977
[ITM294899](#)

Naibar – Owangowan
Circa 1/1/1904–31/12/1977
[ITM294901](#)

Racecourse Creek - Saxby Downs
Circa 1/1/1904–31/12/1977
[ITM294903](#)

Table Mount – Troutbeck
Circa 1/1/1904–31/12/1977
[ITM294905](#)

Wharton Creek - Zig Zag Creek
Circa 1/1/1904–31/12/1977
[ITM294907](#)

Index to registers of runs, LAN/N1

Circa 1/1/1860–31/12/1869

[ITM23302](#) in Index to Various Register of Runs, [S13915](#)

This index is to the various registers of runs or pastoral leases.

Index to registers of pastoral leases or holdings, LAN/N2

Circa 1/1/1863–31/12/1880

[ITM23374](#) in Alphabetical Register of Pastoral Holdings, [S13919](#)

This alphabetical register of pastoral holdings includes names of runs incorporated in pastoral holdings.

Index to pastoral lessees, LAN/N3

Circa 1/1/1860–31/12/1902

[ITM23375](#), [DR65638](#) in Index to Lessees of Runs, [S13920](#)

This index is used to find entries in Registers of Run Lessees, [S13922](#)

Registers of Run Lessees

Circa 1/1/1860–31/12/1902

[S13922](#)

To find entries in these registers use index LAN/N3, [ITM23375](#), [DR65638](#)

Specific records of interest in this series include the following registers:

Register of run lessees (Volume 1)

Circa 1/1/1860–31/12/1902

[ITM23377](#), [DR65639](#)

Register of run lessees (Volume 2)

Circa 1/1/1860–31/12/1902

[ITM23378](#), [DR65641](#)

Register of run lessees (Volume 3)

Circa 1/1/1860–31/12/1902

[ITM23379](#), [DR83350](#)

Register of run lessees (Volume 4)

Circa 1/1/1860–31/12/1902

[ITM23380](#), [DR83351](#)

Register of run lessees (Volume 5)

Circa 1/1/1860–31/12/1902

[ITM23381](#), [DR83352](#)

Register of run lessees (Volume 6)

Circa 1/1/1860–31/12/1902

[ITM23382](#), [DR83353](#)

Register of run lessees (Volume 7)

Circa 1/1/1860–31/12/1902

[ITM23383](#), [DR83354](#)

Index to non-current lessees of Crown Land

Circa 1/8/1885–31/12/1993

[S14000](#)

This card index is used to find land files including pastoral holdings (run files), [S14031](#). The cards are arranged alphabetically and record persons who held some form of Crown leasehold such as pastoral lease, land selection, occupation license, special lease, non-competitive lease, road lease, perpetual lease under the *Land Act of 1884* and subsequent legislation.

Use of the card index is no longer necessary for files in S14050 (LAN/DF1-5106) because these files are listed by selector's names in [ArchivesSearch](#).

In the decades past, to make public records accessible to members of the public, Queensland State Archives (QSA) created microfilm copies of the files. Recently, these microfilms were digitised as PDFs, and the PDFs are available on the Reading Room computers under *Selected QSA records*.

Refer to the following Research Guides for more land record information: [Land Agents' records](#), [Land Codes](#), and [Land tenure records](#).

This card index is partially indexed by QSA online index

[Registers of Lessees of Agricultural and Grazing Farms 1885-1908 \[LAN/P518 Index\]](#)

Pastoral Holdings (Run Files)

Circa 1/1/1850– 2/9/2014

[S14031](#)

To find run files up to 1993, search the index to non-current lessees, [S14000](#). In the decades past, to make public records accessible to members of the public, Queensland State Archives (QSA) created microfilm copies of the files. Recently, these microfilms were digitised as PDFs, and the PDFs are available on the Reading Room computers under *Selected QSA records*.

After 1993, search for the name of the lessee and the run in [ArchiveSearch](#). For more information refer to *Search procedure: Pastoral leases* available in the Reading Room.

Occupation licenses

An occupation license was for a large area of land rented for a maximum of one year from the Crown for pastoral purposes, provided it was not subject to de-pasturing. Similar to the pastoral lease, this land tenure was short-term and generally for a smaller area of land.

Registers of occupation licenses

Circa 8/5/1885–31/12/1980

[S14008](#)

These registers are used to find the occupation license files, [S14005](#). Information includes Land Agent District; date of *Gazette* notice; date and number of application; area; name of applicant; amount of rent paid.

Occupation license files

Circa 1/1/1865–01/01/2013

[S14005](#)

To find occupation license files, search the registers of occupation licenses, [S14008](#), or for more recent files search for the name of the lessee in [ArchiveSearch](#). Files may include the *Government Gazette* notice, application form, description of land, notices of transfer, correspondence with the Lands Department or Land Agent, notification of intention not to renew license, action taken to advertise the land, and letters from persons wanting to rent the land. For more information refer to the [Research Guide to Occupation licenses](#).

Land selections

A selection is an area of land leased from the Crown for agricultural or grazing purposes, such as conditional, unconditional, grazing farm, agricultural farm, grazing homestead, prickly pear, sugar selections, soldier settler selections and perpetual lease selections.

Registers of Selections

8/4/1868– 1/8/1885

[S13945](#)

The registers were used to find selection files in S14033 prior to the selection files being name listed in [ArchivesSearch](#). These registers are indexed by QSA online index, [Applications by Selectors 1868-1885 \(LAN/P54-56\) LAN/P57](#).

If an [online QSA index](#) is available, we recommend researchers search this. The content of online indexes has been sourced directly from original records. Digitised copies of many original registers and indexes are also available in the [QSA catalogue](#), and digitised copies of some microfilmed original records are available on Reading Room computers.

Selection Files

8/4/1868–31/12/1930

[S14033](#)

To find these early land selection files known as LAN/AG files, search [ArchivesSearch](#) for the name of the selector. These files are about the administration of land selected under *Land Acts 1868 to 1884*. The files may include the application to select, description, survey plan, lease, proof of fulfilment of conditions, certificate of fulfilment of conditions, *Government Gazette* notices, transfer of lease, forfeiture of selection, reversal of forfeiture, application to purchase, issue of deed of grant, and correspondence. If you do not find the name of the selector, search the appropriate Register of Selection, [S13945](#) for more information.

Index to non-current lessees of Crown Land

Circa 1/8/1885–31/12/1993

[S14000](#)

This card index is used to find land files including pastoral holdings (run files), [S14031](#). The cards are arranged alphabetically and record persons who held some form of Crown leasehold such as pastoral lease, land selection, occupation license, special lease, non-competitive lease, road lease, perpetual lease under the *Land Act of 1884* and subsequent legislation.

Use of the card index is no longer necessary for files in S14050 (LAN/DF1-5106) because these files are listed by selector's names in [ArchivesSearch](#).

In the decades past, to make public records accessible to members of the public, Queensland State Archives (QSA) created microfilm copies of the files. Recently, these microfilms were digitised as PDFs, and the PDFs are available on the Reading Room computers under *Selected QSA records*.

Refer to the following Research Guides for more land record information: [Land Agents' records](#), [Land Codes](#), and [Land tenure records](#).

This card index is partially indexed by QSA online index

[Registers of Lessees of Agricultural and Grazing Farms 1885-1908 \[LAN/P518 Index\]](#)

Dead Farm Files

Circa 30/6/1831–4/12/2012

[S14050](#)

This series is files on agricultural farm leases, grazing homestead leases and perpetual lease selections, now known as freeholding leases.

To find files search for the name of the lessee in [ArchiveSearch](#).

The files include the application form, license to occupy, maps, survey plans, description of land, reports, transfers, certificate of performance of conditions of selection, lease, *Government Gazette* notices, changes of tenure, application for freeholding and correspondence with selectors. Sometimes there are death or marriage certificates and copies of wills.

Register of Lands Open for selection and purchase

Circa 1/1/1861–31/1/1867

[S16128](#)

This register known as SUR/6 is indexed by QSA online index [Register of lands 1861-1868](#).

Registers of Agricultural Reserve leases

Circa 1/12/1866–29/2/1868

[S16150](#)

These registers known as SUR/7-11 are indexed by QSA online index [Register of lands 1861-1868](#).

Register of Agricultural Reserve leases, 1866-1868,

Circa 1/11/1866–29/2/1868

[ITM101533](#) SUR/12 in [S16122](#)

This register issued for portions of agricultural reserves is arranged by agricultural reserve lease name.

Index to Agricultural Reserve leases

Circa 1/12/1866–29/2/1868

[ITM101536](#) SUR/15 in [S16125](#)

This index of agricultural reserve reserves is arranged by name of lessee.

Register of Applications for Selections, under Section 67 of the *Crown Lands Alienation Act 1868*

Circa 1/1/1868–31/3/1869

[ITM76341](#) in [S14073](#)

Information in the register includes application number, correspondence reference, name of lessee, name of agricultural reserve, number of portion/s, area, date of selection, county, parish, dates of payment, particulars of payment, amount, transfers, whether purchased or new reference number, and date the deed was prepared.

Register of offers to surrender land, or the acquisition of land for selections under the *Agricultural Lands Purchase Act 1894*

Circa 3/7/1894–29/12/1929

[ITM22387](#) in [S13839](#)

This register records the offers from land owners. Included is the date of receipt of offer; the name of the owner; name of property or parish; area; price per acre and total price. Some entries give the date referred to the Land Board and the decision.

Land Agent's District of Ipswich, selections in the Rosewood and Lake Clarendon Estates under the *Agricultural Land Purchase Act 1894*

12/5/1896–3/3/1913

[ITM22395](#) in [S13955](#)

Applications to Lease Vacant Crown Land

9/7/1954–1/1/2013

[S20543](#)

The files contain applications, plans, valuation reports and correspondence between the Departments, land inspectors and Shire Councils. For more information refer to the *Search procedure: Land selections* in our Reading Room.

Special leases

Special leases were granted for a wide variety of purposes including wharf sites, quarries, accommodation houses, guano, flour mills, sawmills, fishing stations.

Index to non-current lessees of Crown Land

Circa 1/8/1885–31/12/1993

[S14000](#)

This card index is used to find land files including special leases, [S18005](#). The cards are arranged alphabetically and record persons who held some form of Crown leasehold such as pastoral lease, land selection, occupation license, special lease, non-competitive lease, road lease, perpetual lease under the *Land Act of 1884* and subsequent legislation.

Use of the card index is no longer necessary for files in S14050 (LAN/DF1-5106) because these files are listed by selector's names in [ArchivesSearch](#).

In the decades past, to make public records accessible to members of the public, Queensland State Archives (QSA) created microfilm copies of the files. Recently, these microfilms were digitised as PDFs, and the PDFs are available on the Reading Room computers under *Selected QSA records*.

Refer to the following Research Guides for more land record information: [Land Agents' records](#), [Land Codes](#), and [Land tenure records](#).

This card index is partially indexed by QSA online index

[Registers of Lessees of Agricultural and Grazing Farms 1885-1908 \[LAN/P518 Index\]](#)

Registers of Special Leases

20/3/1868–31/12/1981

[S14016](#)

These registers are used to find special lease files, [S18005](#). Information in the registers changed over time. Details include number of application (lease), date application received, name of applicant, term of lease, rent paid, locality, purpose, description of land, details of transfer of mortgage.

Special leases

Circa 1/1/1860–1/5/2013

[S18005](#)

Special lease files may include maps, correspondence, *Government Gazette* notices, applications, descriptions of the land, notices from Treasury about payments, transfers, lease documents, conditions of lease, and details of mortgage. For more information refer to the [Research Guide to Special leases](#).

Freehold

Crown Land becomes freehold when the land is sold, and the buyer is issued with a Deed of Grant by the Governor in Council.

Freehold land titles – Old system to Torrens system administrative transfer (application packets)

Circa 01/01/1859-31/12/1995

[S21687](#)

This series contains application packets relating to the management of freehold titles in Queensland. Prior to 1862 all freehold titles in Queensland were managed under the Old system, which Queensland inherited from New South Wales. In the beginning of 1862 a new management system, the Torrens system, was introduced. From 1862-1974 the transfer of freehold titles from the Old system to the Torrens system was completed on an ad hoc basis. In 1974 it was decided that an active effort would be made to ensure all titles were transferred from the Old system to the Torrens system. This process was completed in 1994. To initiate the process, landowners were required to complete a transfer request form, provide their Deed of Grant and any Certificates of Indenture, which documented mortgages and conveyances. All relevant information and documentation relating to a transfer was compiled and stored in an application packet and assigned a unique transfer application number. The purpose of the application number was to link documentation associated with the management of land under the Old system with post-transfer documentation created under the Torrens system.

Indexes to Land Purchases

Circa 1/1/1860–31/12/1921

[S10397](#)

These indexes are used to find the original certificates of title in Triplicate Deeds of Grant - Town Lot B Registers, [S46](#) and Triplicate Deeds of Grant - Land Purchase A Registers, [S47](#) from 1860 to 1921.

Specific records of interest in this series are:

Index to lands purchases - town

Circa 1/1/1901–31/12/1921

[ITM308613, DR50924](#)

Index to lands purchases - country

Circa 1/1/1890–31/12/1921

[ITM308615, DR51561–DR51563](#)

Index to lands purchases - town (Town Lot B)

Circa 1/1/1860–31/12/1900

[ITM308612, DR51543 & DR51557](#)

Index to lands purchases - country (Land Purchase A)

Circa 1/1/1860–31/12/1889

[ITM308614, DR51558– DR51560](#)

Card Index to Triplicate Deeds of Grant [alphabetical by Surname]

Circa 1/1/1922- 31/12/1965

[S266](#)

Details include name of purchaser/grantee, date of the deed, portion number, parish, area, volume number, and folio number (ie. page number).

Card Index to Triplicate Deeds of Grants [chronological]

Circa 1/1/1964- 31/12/1978

[S265](#)

Details include name of purchaser/grantee, the parish (town), portion/tenure, lease reference, volume number and folio number (ie. page number).

Triplicate Deeds of Grant - Town lot B registers

30/08/1860– 21/12/1921

[S46](#)

To find original certificates of title/deeds of grant, search Indexes to Land Purchases (town and country) 1860–1921, [S10397](#)

Triplicate Deeds of Grant - Land purchase A registers

28/08/1860–31/8/1991

[S47](#)

To find original certificates of title/deeds of grant from 1860–1921 search Indexes to Land Purchases (town and country), [S10397](#) ; from 1922–1965 search Card Index to Triplicate Deeds of Grant [alphabetical by Surname], [S266](#) ; from 1964–1978 search Card Index to Triplicate Deeds of Grants [chronological], [S265](#).

Sales of Crown Land and special leases

19/12/1859–31/12/1962

[S14026](#)

Details include date and place of sale, date of proclamation, a description of the land, upset price per acre. For the late nineteenth and twentieth centuries these lists include sales of perpetual leases.

Reports of the sales of Crown Land

16/5/1859–26/6/1915

[S14038](#)

Lists of Land Sold - Colony of Queensland

Circa 1/9/1842–31/8/1859

[ITM101517](#), [DR51698](#) in [S16119](#), SUR/4

Details include the date of sale or offer at auction, lot number, county, parish town or place, area, allotment or portion, upset price, price realized, amount of purchase money, purchaser and residence. Also see the QSA online index [Register of lands sold 1849-1861](#).

Register of Lands Sold

19/4/1849–21/2/1861

[ITM101547](#), [DR50923](#) in [S16130](#), SUR/5

Sale of land at Ipswich, Brisbane, Warwick, Drayton, Rockhampton, Dalby, Maryborough, Gayndah, Callandoon, Condamine, Gladstone. Details include the date of sale or offer at auction, lot number, county, parish town or place, area, allotment or portion, upset price, price realized, amount of purchase money, purchaser and residence. Also see the QSA online indexes [Register of lands sold 1849-1861](#) and [Register of lands 1861-1868](#)

Register of Lands

Circa 1/1/1861–31/12/1867

[ITM101539](#) in [S16128](#), SUR/6

Register of lands open for selection, and purchase. Also see the QSA online indexes [Register of lands sold 1849-1861](#) and [Register of lands 1861-1868](#)

Registers of Land Purchase Deeds under Pre-Emptive Right

24/6/1860–22/10/1885

[S10373](#)

Copies of deeds issued under New South Wales land regulations. There are only two deeds issued after 1869.

Registers of Sales of Crown Lands, Country Lands

22/5/1860–2/5/1959

[S9977](#)

These registers were created by the Survey Office for information to add to maps. Details may include portion number, name of purchaser and amount realised.

Registers of Sales of Crown Lands, Town and Suburban Lands

16/1/1855–18/3/1959

[S9963](#)

These registers were created by the Survey Office for information to add to maps. Details may include portion number, name of purchaser and amount realised. For more information refer to the *Search procedure: Deeds of Grant* available in our Reading Room.

Other sources of information

- Refer to the [Research guide to Land codes](#) to identify series of land files available at QSA.
- Refer to the other [Research Guides](#) about land records for detail about specific land tenure forms.
- *New South Wales Government Gazettes* to 1859 and *Queensland Government Gazettes* from 1859 onwards contain details of all land tenure types. The *Queensland Government Gazettes* are available online to 1900 on [Text Queensland](#). For more information about land tenure listings in the *New South Wales Government Gazette*, you may want to contact the [Museum of Lands Mapping and Surveying](#).
- A range of [land indexes available online](#) on the [QSA website](#). These include:
 - Register of land sold 1842–1859
 - Register of lands sold 1849–1861
 - Register of lands 1861–1868
 - Rents Payable (Treasury) Pastoral Runs Index 1860–1911
 - Registers of Lessees of Agricultural and Grazing Farms 1885–1908 [LAN/P518 Index]
 - Applications by Selectors 1868–1885 (LAN/P54-56) LAN/P57
 - Land selections 1885–1981
 - Register of pastoral holdings 1863–1880
 - Perpetual Lease Selections of soldier settlements 1917–1929

Historical title searches

For subsequent transactions of properties, contact [Titles Queensland](#). You can purchase historical title searches and supplements either online, in person or by phone. These documents show all interests registered against the title.

Need more information?

Check our online catalogue [ArchivesSearch](#).
Phone us on (07) 3037 6777 or you can [email](#) an archivist.